



For Sale

4,650 s.f. Commercial / Office Condo

#144, 134 Pembina Road
Sherwood Park, AB

- › Property built in 2009 in well located Westana Village in Sherwood Park
- › Quick access to Yellowhead Trail via Broadmoar Boulevard
- › 2,325 SF main floor and 2,325 SF 2nd floor
- › Ample parking available
- › Ideal for retail or office users
- › Large front windows
- › Additional double man doors can be added
- › Due diligence package available
- › Zoning is DC 48 Area A
- › Power is 200 Amp, 240 Volt (TBC)



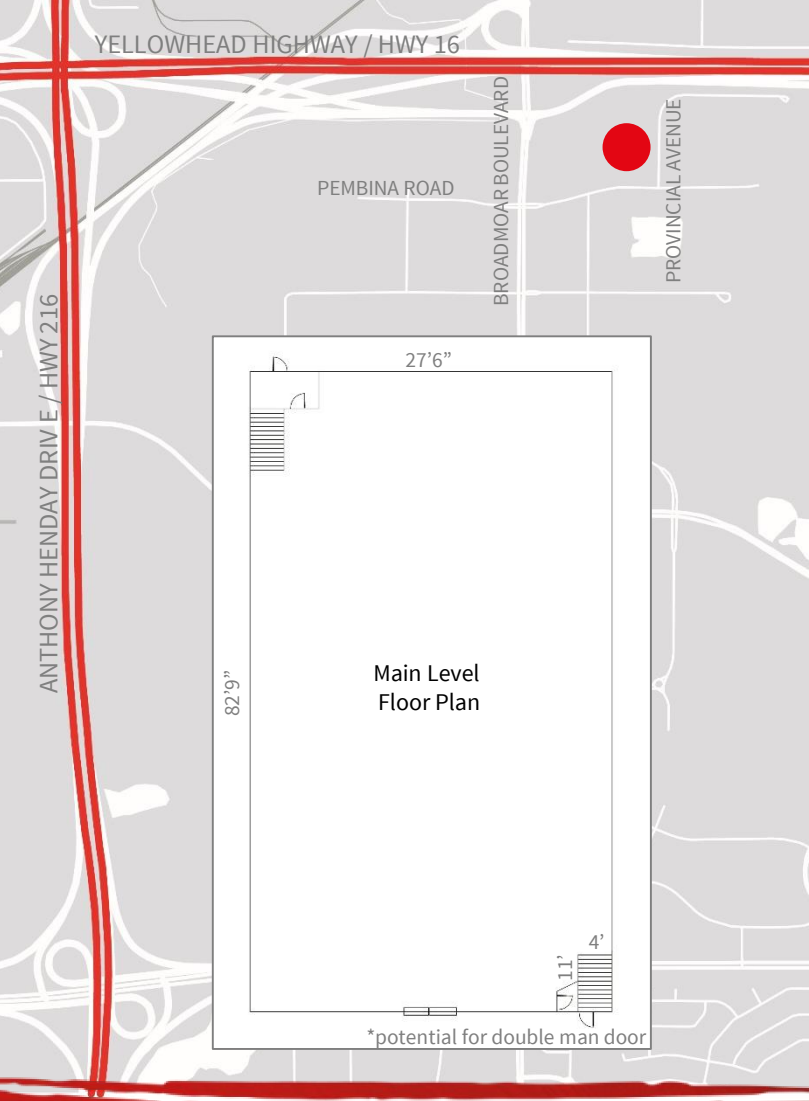

Property Information

Unit Size	Main Floor: 2,325 s.f. 2 nd Floor: 2,325 s.f. Total Area: 4,650 s.f.
Legal Address	Condo Plan 082850, Unit 4
Lighting	Fluorescent
Heating	2 roof top units with A/C
Loading	Potential to add double man doors
Ceiling Height	Main Floor: 9'9" 2 nd Floor: 11'8"
Taxes	\$9,156.16 (2017)
Condo Fees	\$649.33/month (2017)
Available	Immediately
Sale Price	\$830,000

Contact the JLL Edmonton Industrial Team

Angela Wu-Kemp
Associate Vice President
+1 780 328 0067
angela.wu-kemp@am.jll.com

Andres Mateluna
Senior Associate
+1 780 328 2557
andres.mateluna@am.jll.com

David Kraus
Vice President, Associate Broker
+1 780 328 0068
david.kraus@am.jll.com

Adam Butler
Associate Vice President
+1 780 328 0065
adam.butler@am.jll.com

Jim Bijou, SIOR
Senior Vice President
+1 780 328 2551
jim.bijou@am.jll.com

Darryl McGavigan
Vice President
+1 780 328 0064
darryl.mcgavigan@am.jll.com

Wendy Phanthikane
Brokerage Coordinator
+1 780 328 2555
wendy.phanthikane@am.jll.com

Ashley Hodgins
Brokerage Coordinator
+1 780 328 0069
ashley.hodgins@am.jll.com



JLL Edmonton Industrial
Suite 2101, TD Tower
10088 102 Avenue NW
Edmonton, Alberta T5J 2Z1