

# @BrickstoneSquare

Where work meets lifestyle

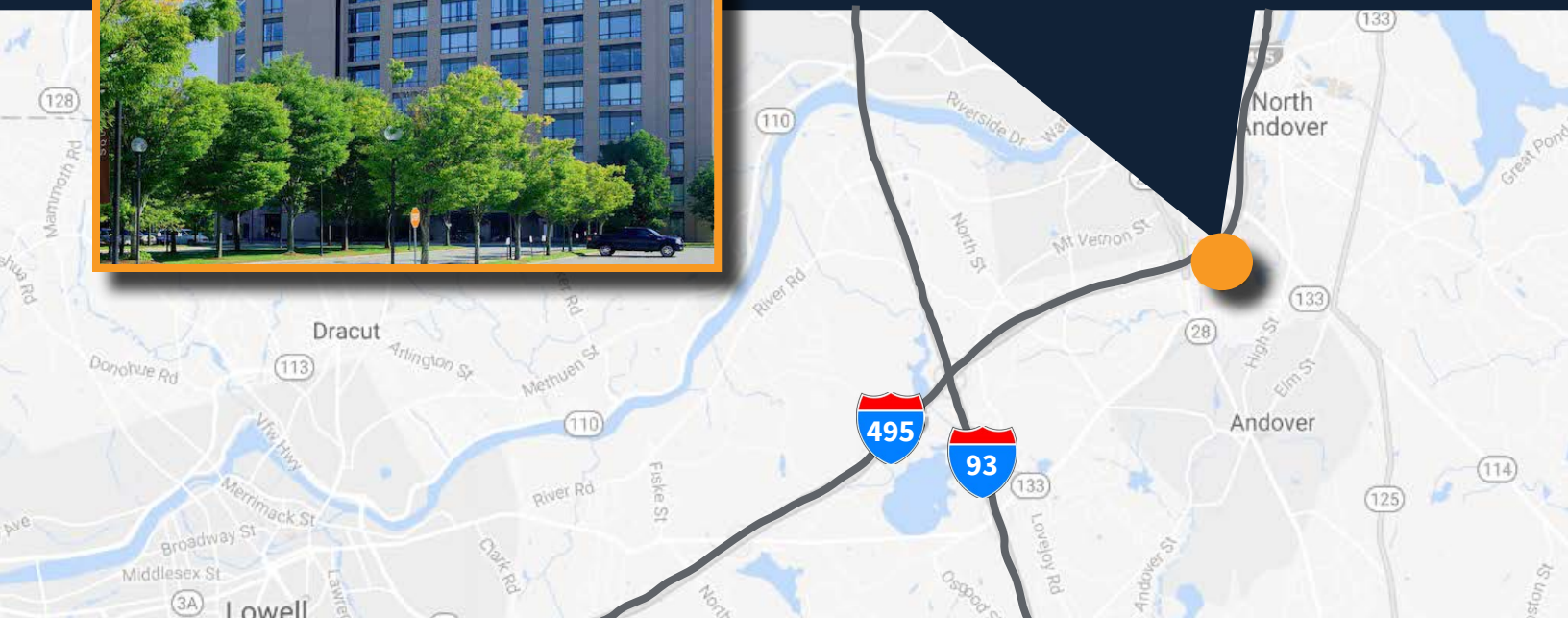

**12,796 SF**  
*Sublease Opportunity*



JLL is pleased to present approximately a 12,796 SF sublease within 300 Brickstone Square in Andover Massachusetts. A three-building campus offering 3,000 parking spots, including an 800-car garage and major capital improvements within the campus. Immediately off of Route 495 and a short 1.5 miles away from Downtown Andover which includes a wealth of amenities, 300 Brickstone Square is a tenants ideal amenity driven campus.

**ON-SITE AMENITIES:**



**375 SEAT CAFE**



**CONFERENCE CENTER  
(20-100 PEOPLE)**



**GAME ROOM**



**CAFE**

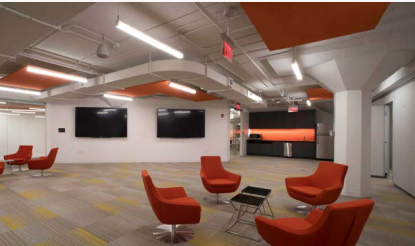

**FITNESS CENTER & YOGA ROOM**

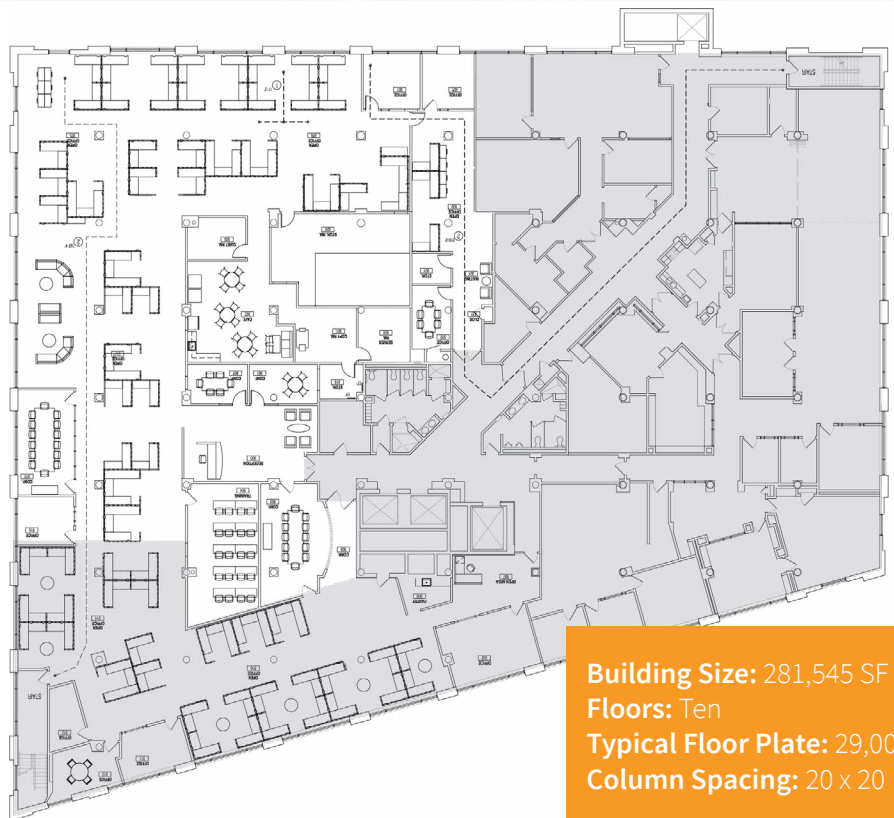

**Brian Tisbert**  
Executive Vice President  
617-531-4115  
Brian.Tisbert@am.jll.com

**Chris Lawrence**  
Managing Director  
617-316-6529  
Christopher.Lawrence@am.jll.com



**Building Size:** 281,545 SF  
**Floors:** Ten  
**Typical Floor Plate:** 29,000 RSF  
**Column Spacing:** 20 x 20