

1380 Rodick Road, Markham

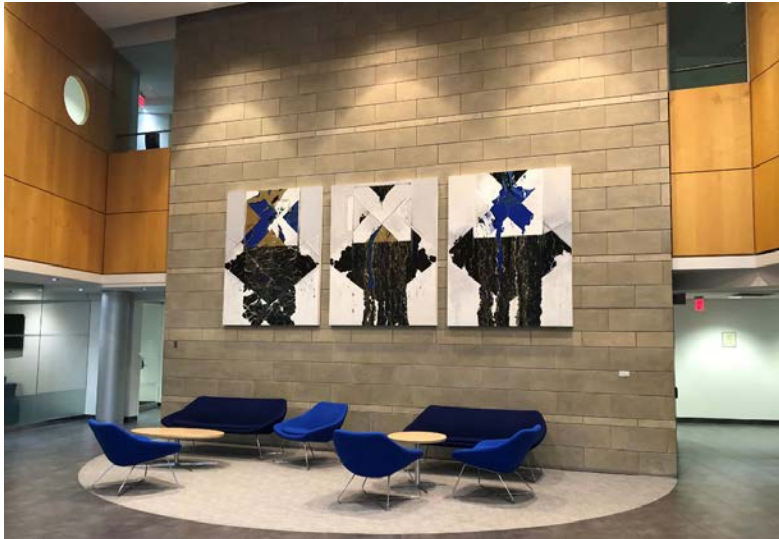

For Sublease

New Sublease Opportunity!



PROPERTY DETAILS

SIZE

1st Floor 7,075 sq. ft.

AVAILABILITY

Q2 2020

EXPIRY

September 29th, 2025

NET RENT

Call Listing Agents

ADDITIONAL RENT

\$15.00 psf (est. 2019)

- Plug and Play sublease opportunity with high-end finishes
- Mix of offices, meeting rooms, kitchen and open area
- Some furniture available
- "A" Class building
- Public transit access
- On-Site restaurant
- Free surface parking at 4:1,000 SF leased

For Sublease

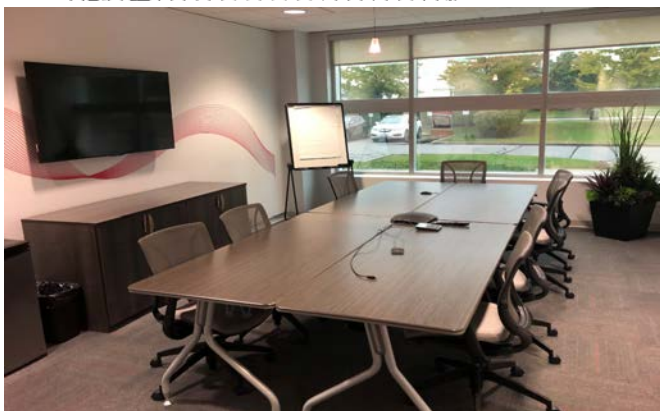
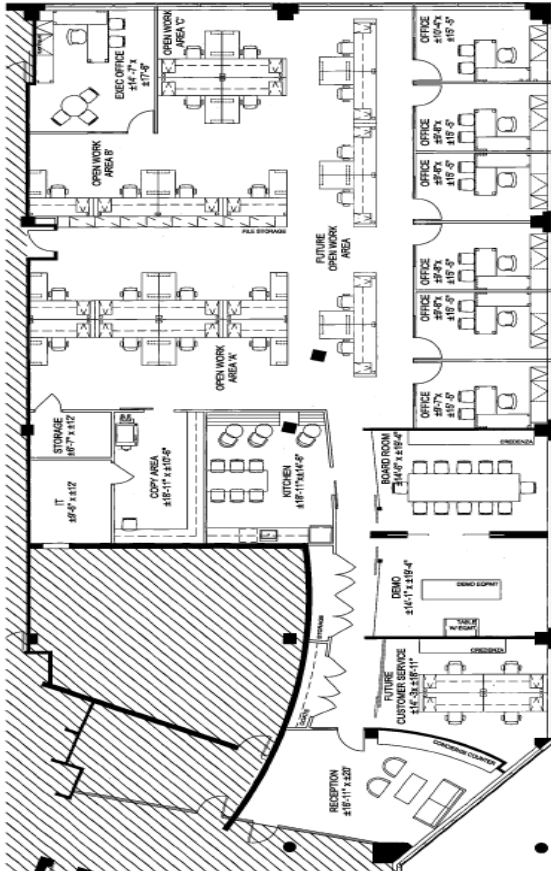

For more information, contact:

Erik Smith*
Vice President
+1 647 339 7145
erik.smith@am.jll.com

Glenn Thackeray*
Vice President
+1 416 304 6058
glenn.thackeray@am.jll.com

DISCLAIMER
Although information has been obtained from sources deemed reliable, neither Owner nor JLL makes any guarantees, warranties or representations, express or implied, as to the completeness or accuracy as to the information contained herein. Any projections, opinions, assumptions or estimates used are for example only. There may be differences between projected and actual results, and those differences may be material. The Property may be withdrawn without notice. Neither Owner nor JLL accepts any liability for any loss or damage suffered by any party resulting from reliance on this information. If the recipient of this information has signed a confidentiality agreement regarding this matter, this information is subject to the terms of that agreement. ©2018 Jones Lang LaSalle IP, Inc. All rights reserved. *Salesperson
**Broker