



# For Lease

Brand new neighbourhood retail  
from 1,566 s.f. to 6,955 s.f.

- Convenient access to 170th Street and Anthony Henday Drive
- Multiple size options available
- Great signage opportunities
- Abundant residential growth in the area
- No competition in the neighbourhood
- Possession Summer 2020

## Glenriding Commercial

21 Avenue SW & Rabbit Hill Road  
Edmonton, AB

---

### Paul Raimundo

Vice President

+1 780 328 2575

[paul.raimundo@am.jll.com](mailto:paul.raimundo@am.jll.com)

### Bruce Peters

Assistant Vice President

+1 780 328 2577

[bruce.peters@am.jll.com](mailto:bruce.peters@am.jll.com)



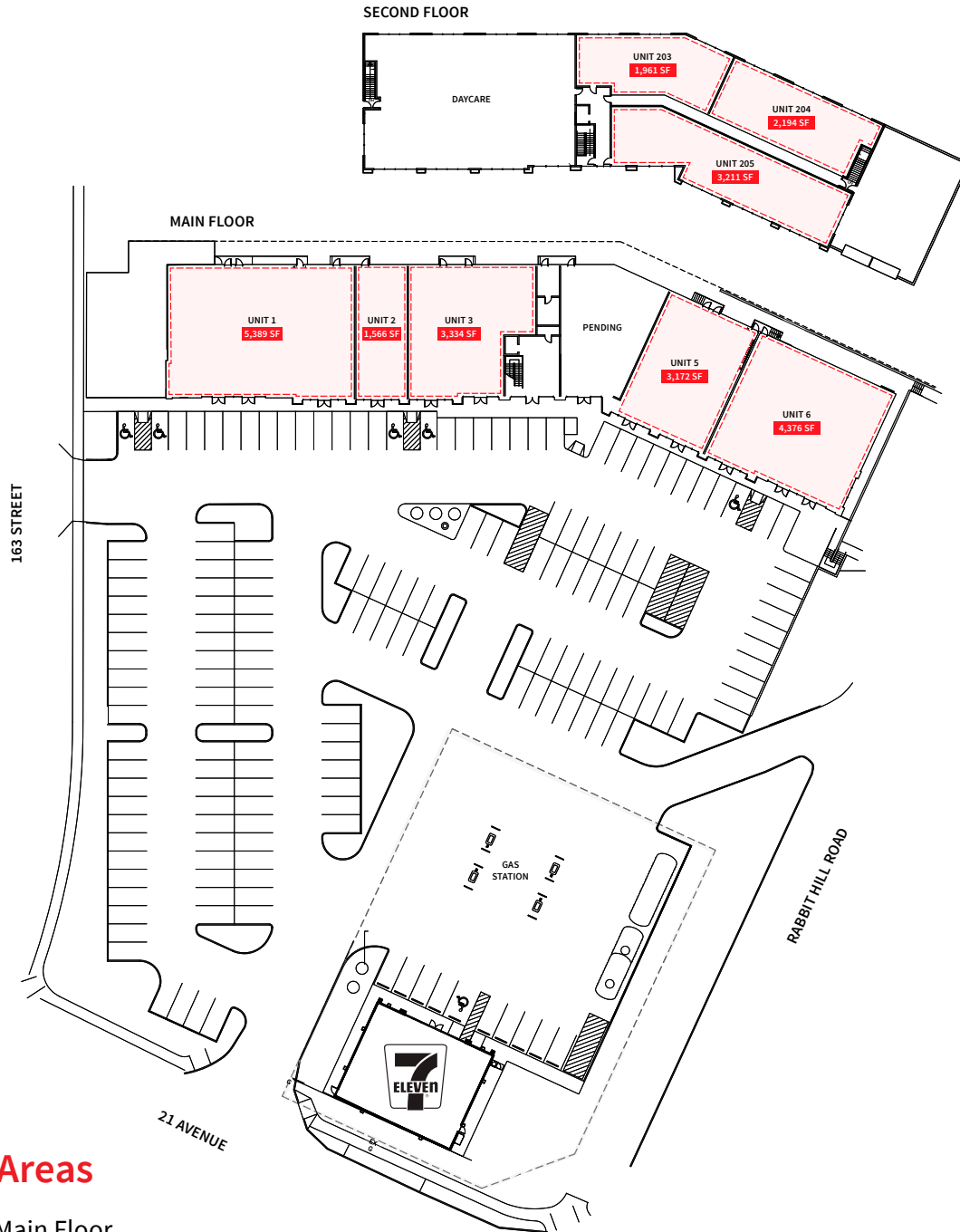

## Leasable Areas

- Building A - Main Floor
  - Unit 1 5,389 s.f.
  - Unit 2 1,566 s.f.
  - Unit 1 + 2 6,955 s.f.
  - Unit 3 3,334 s.f.
  - Unit 5 3,172 s.f.
  - Unit 6 4,376 s.f.
- Building A - Second Floor
  - Unit 203 1,961 s.f.
  - Unit 204 2,194 s.f.
  - Unit 205 3,211 s.f.

## Details

- Lease Rate \$35.00 p.s.f.
- Op. Costs \$11.00 p.s.f. (2018 estimate)
- Parking 145 stalls
- Zoning CB1 - Low Intensity Business Zone

# Glenriding Commercial

For Lease —  
Glenriding Commercial



## Area Structure Plan

- Single / Semi-Detached Residential
- Row Housing
- Low-Rise / Medium Density Housing
- Neighbourhood Commercial
- Stormwater Management Facility
- Urban Village Park
- District Park

**BYLAW 16740 APPROVED GLENRIDGING HEIGHTS**  
Neighbourhood Structure Plan (as amended)

**Note —**  
Location of collector roads and configuration of stormwater management facilities are subject to minor revisions during subdivision and rezoning of the neighbourhood and may not be developed exactly as illustrated.

## Area Demographics



### Average Household Income (2018)

1 km: \$146,134  
3 km: \$158,592  
5 km: \$161,174



### Total Population (2018)

1 km: 3,944  
3 km: 31,095  
5 km: 75,001



### Daytime Population (2018)

1 km: 2,022  
3 km: 15,043  
5 km: 40,597

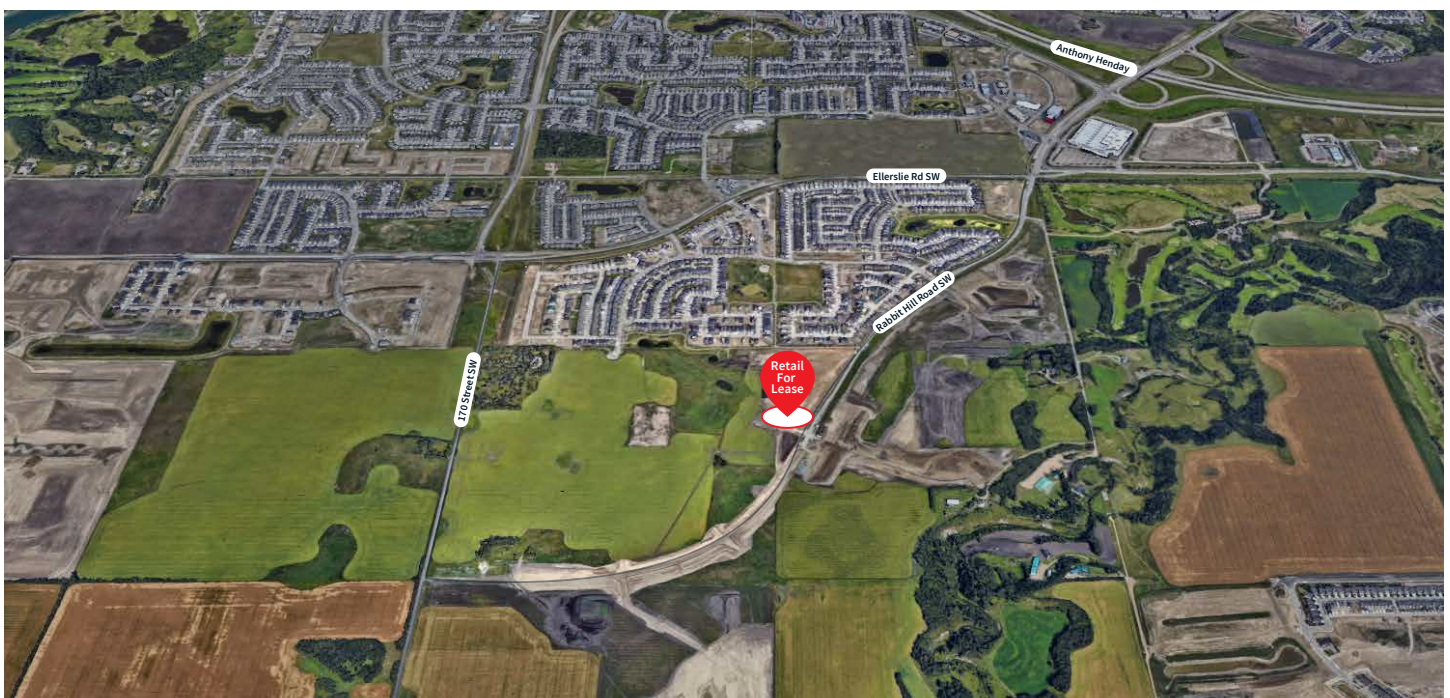

GLENRIDGING HEIGHTS AERIAL

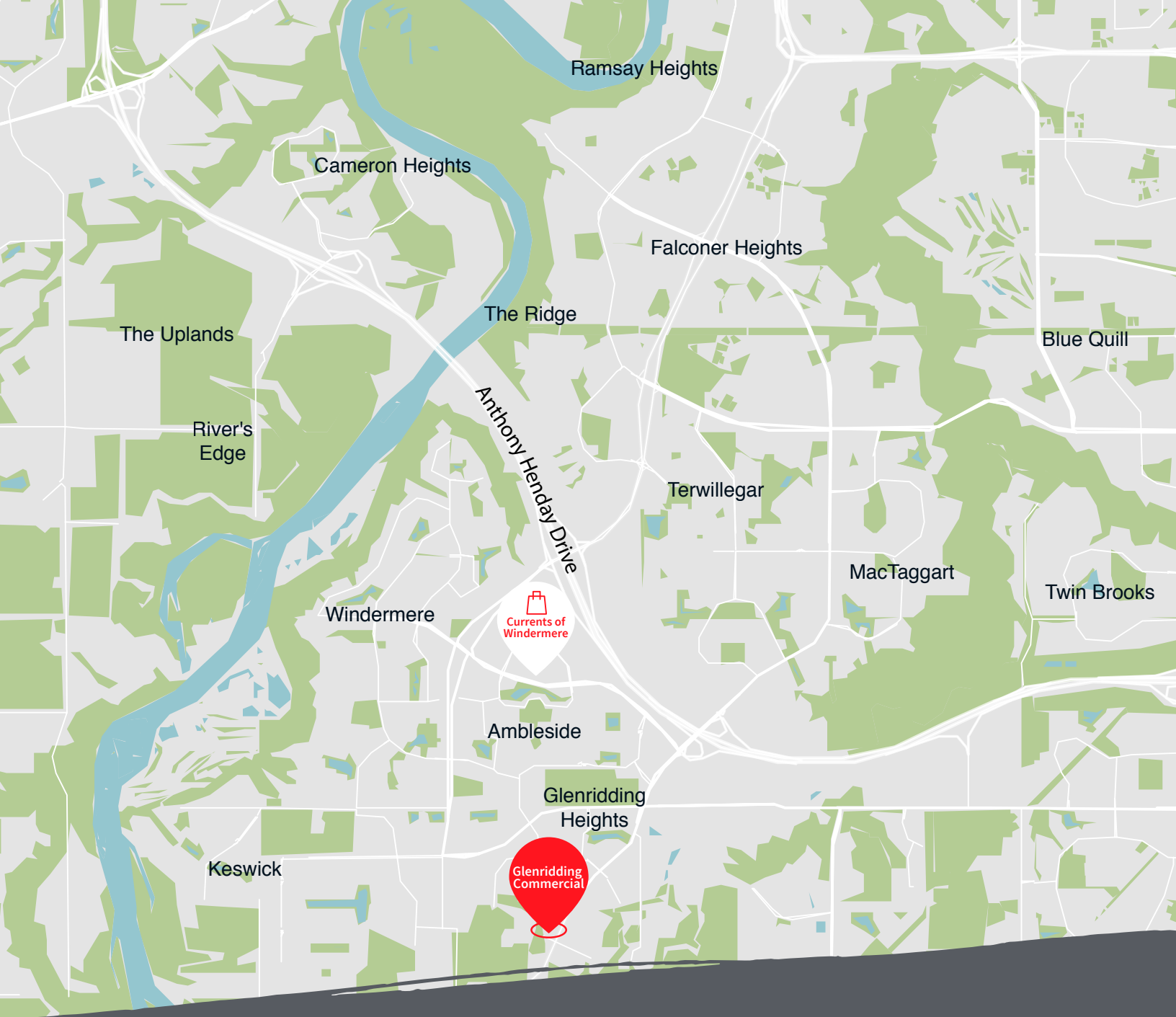

## Contact Us

### Paul Raimundo

Vice President

+1 780 328 2575

paul.raimundo@am.jll.com

### Bruce Peters

Assistant Vice President

+1 780 328 2577

bruce.peters@am.jll.com



DISCLAIMER: Although information has been obtained from sources deemed reliable, neither Owner nor JLL makes any guarantees, warranties or representations, express or implied, as to the completeness or accuracy as to the information contained herein. Any projections, opinions, assumptions or estimates used are for example only. There may be differences between projected and actual results, and those differences may be material. The Property may be withdrawn without notice. Neither Owner nor JLL accepts any liability for any loss or damage suffered by any party resulting from reliance on this information. If the recipient of this information has signed a confidentiality agreement regarding this matter, this information is subject to the terms of that agreement. ©2019. Jones Lang LaSalle IP, Inc. All rights reserved.

**JLL Edmonton Retail**  
Suite 2101 TD Tower  
10088 102 Ave. NW  
Edmonton, AB, T5J 2Z1