

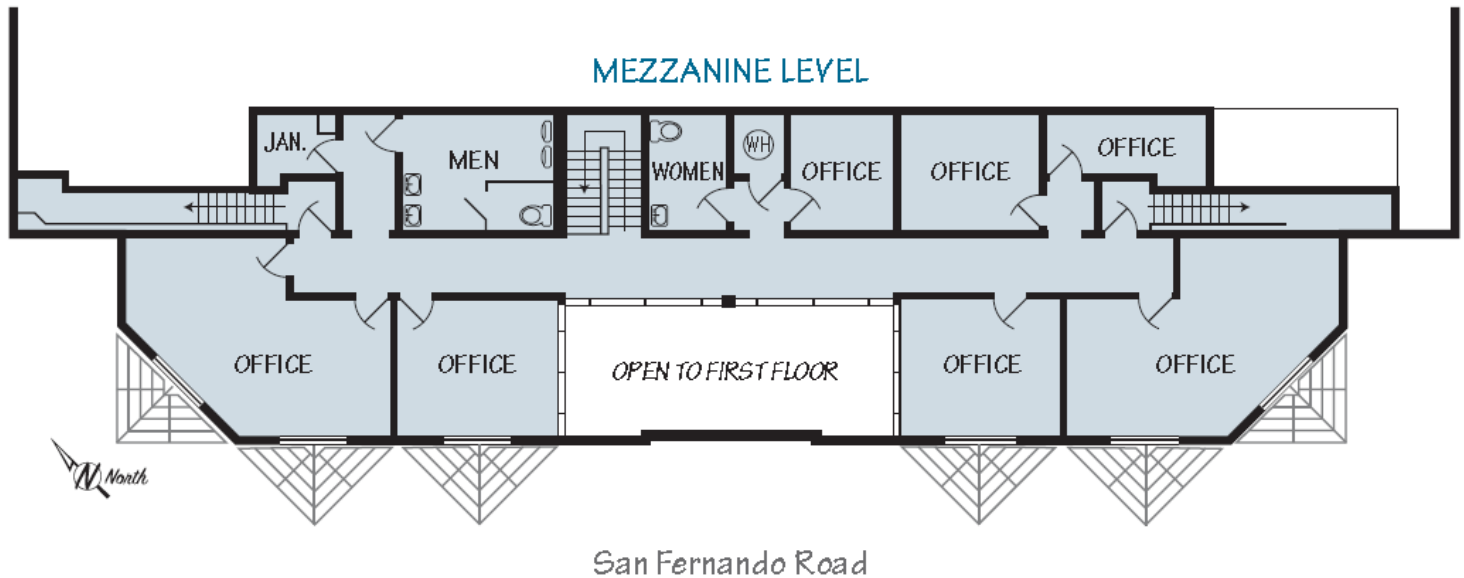

Available for Lease

3,800 s.f.

1600 N. San Fernando Blvd. • Los Angeles • California



Property overview

- Well Appointed Spacious Offices
- Close to LA River
- Freeway Accessible (5, 2, and 110)
- Part of the Greek Marble Facility
- Separate Entry
- Ample Parking
- Fenced Yard



Contact exclusive brokers:

Paul Sablock, SIOR

Executive Vice President
+1 213 239 6230
paul.sablock@am.jll.com
License#: 00783445

Karina Saranovic

Associate
+1 213 239 6298
karina.saranovic@am.jll.com
License#: 01875758