



# For Sale or Lease

**35,239 square foot shop facility on  
8.60 acres in the heart of Nisku**

- Freestanding, well-equipped shop facility with a fully fenced, developed, and secure site
- Large portion of the site is concrete with a newer asphalt parking area with over 100 vehicles
- Security features include cameras, alarms, and yard lighting
- Power, upgraded compressor lines, and fall-restraint systems throughout the shop
- Upgraded office area plus employee areas with change rooms, lunch rooms, and training facilities
- Excellent access to the Nisku Spine Road and QEII Highway

**Altafab Travco Facility  
1507 8 Street, Nisku, AB**

**David Kraus**

+1 780 328 0068

[david.kraus@am.jll.com](mailto:david.kraus@am.jll.com)

**Darryl McGavigan**

+1 780 328 0064

[darryl.mcgavigan@am.jll.com](mailto:darryl.mcgavigan@am.jll.com)

**Adam Butler**

+1 780 328 0065

[adam.butler@am.jll.com](mailto:adam.butler@am.jll.com)

**Jim Bijou**

+1 780 328 2551

[jim.bijou@am.jll.com](mailto:jim.bijou@am.jll.com)

**Andres Mateluna**

+1 780 328 2557

[andres.mateluna@am.jll.com](mailto:andres.mateluna@am.jll.com)



## *Property Details*

- Building Area: 35,329 square feet
- Yard Area: 8.60 acres
- Site Coverage: 9%
- Zoning: IND - Industrial
- Power: 400 amp, 600 volt, 3 phase (TBC)
- Heating: Radiant tube, forced air, air exchange
- Lighting: T5 and mercury vapour
- Sprinklered: Yes
- Loading:
  - Five 16' x 18' grade doors
  - Three 10' x 12' grade doors
  - One exterior dock door
- Ceiling Height: 23 - 27'5" under truss
- Crane: One 5-ton bridge crane
- Chattels include lunch room and office trailers





# Floor Plan

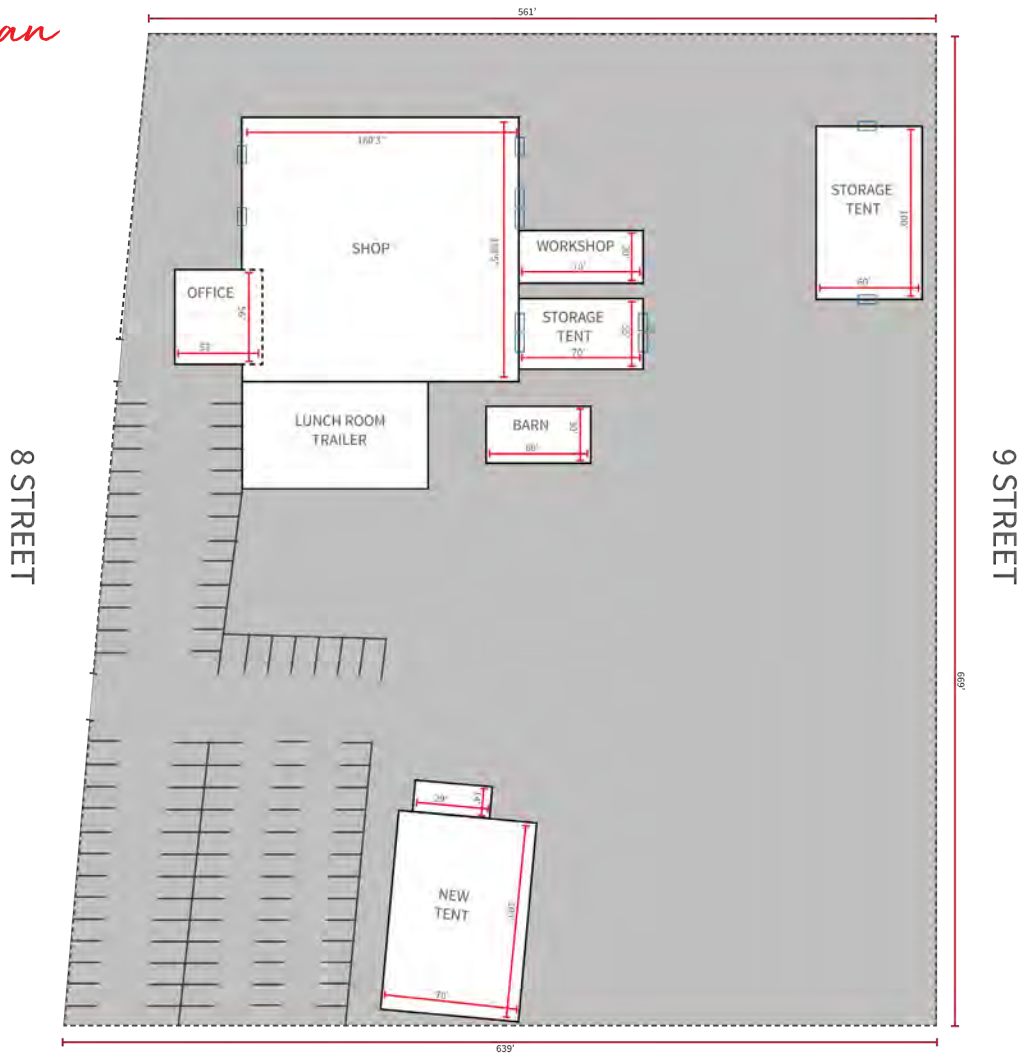

\*All dimensions are approximate



## Sale & Lease Details

Sale Price: \$6,300,000

Lease Rate: \$12.00 per square foot

Op Costs: TBD

Available: Immediately





## Contact the Edmonton Industrial Sales & Leasing Team

**David Kraus**

Senior Vice President

+1 780 328 0068

[david.kraus@am.jll.com](mailto:david.kraus@am.jll.com)

**Adam Butler**

Vice President

+1 780 328 0065

[adam.butler@am.jll.com](mailto:adam.butler@am.jll.com)

**Andres Mateluna**

Senior Associate

+1 780 328 2557

[andres.mateluna@am.jll.com](mailto:andres.mateluna@am.jll.com)

**Karrone Young**

Marketing Coordinator

+1 780 328 2583

[karrone.young@am.jll.com](mailto:karrone.young@am.jll.com)

**Darryl McGavigan**

Senior Vice President

+1 780 328 0064

[darryl.mcgavigan@am.jll.com](mailto:darryl.mcgavigan@am.jll.com)

**Jim Bijou**

Senior Vice President

+1 780 328 2551

[jim.bijou@am.jll.com](mailto:jim.bijou@am.jll.com)

**Ashley Hodgins**

Brokerage Coordinator

+1 780 328 0069

[ashley.hodgins@am.jll.com](mailto:ashley.hodgins@am.jll.com)

**Daniel Toumine**

Research Analyst

+1 780 328 0070

[daniel.toumine@am.jll.com](mailto:daniel.toumine@am.jll.com)

DISCLAIMER: Although information has been obtained from sources deemed reliable, neither Owner nor JLL makes any guarantees, warranties or representations, express or implied, as to the completeness or accuracy as to the information contained herein. Any projections, opinions, assumptions or estimates used are for example only. There may be differences between projected and actual results, and those differences may be material. The Property may be withdrawn without notice. Neither Owner nor JLL accepts any liability for any loss or damage suffered by any party resulting from reliance on this information. If the recipient of this information has signed a confidentiality agreement regarding this matter, this information is subject to the terms of that agreement. ©2019. Jones Lang LaSalle IP, Inc. All rights reserved.

**JLL Edmonton Industrial**  
Suite 2101 TD Tower  
10088 102 Ave. NW  
Edmonton, AB, T5J 2Z1