

**\*New to the Market**

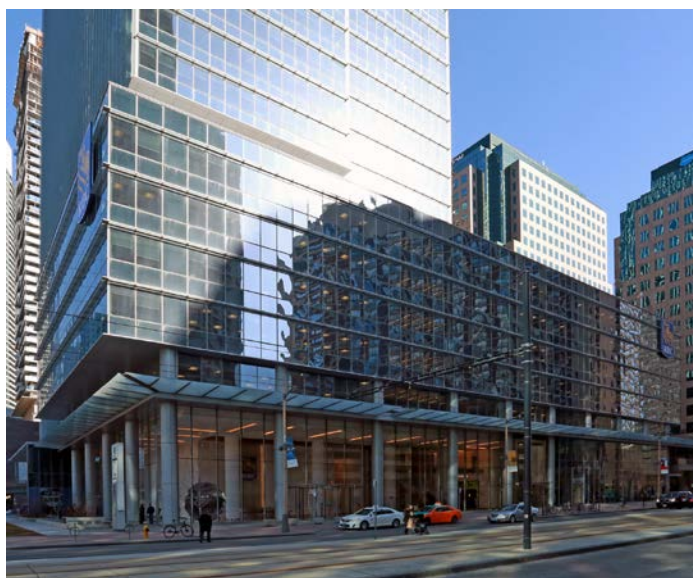

# Full Floor Sublease

## 88 Queens Quay – Waterpark Place



### PROPERTY DETAILS

**SUITE SIZE:**

27<sup>th</sup> Floor – 27,518 sq. ft.

**NET RENT:**

Contact Listing Agent

**TERM:**

April 30th, 2025

**ADDITIONAL RENT:**

\$25.65 (2019 estimate)

**AVAILABLE:**

Immediately

### SPACE HIGHLIGHTS

- Full Floor sublease opportunity
- Newest tower in Waterpark Place
- Furniture potentially available
- Ample retail amenities on ground and 2<sup>nd</sup> floor level
- Connected through PATH to Union Station and subway
- Large food court with a Tim Hortons and Starbucks

# For Sublease

## 27<sup>th</sup> Floor

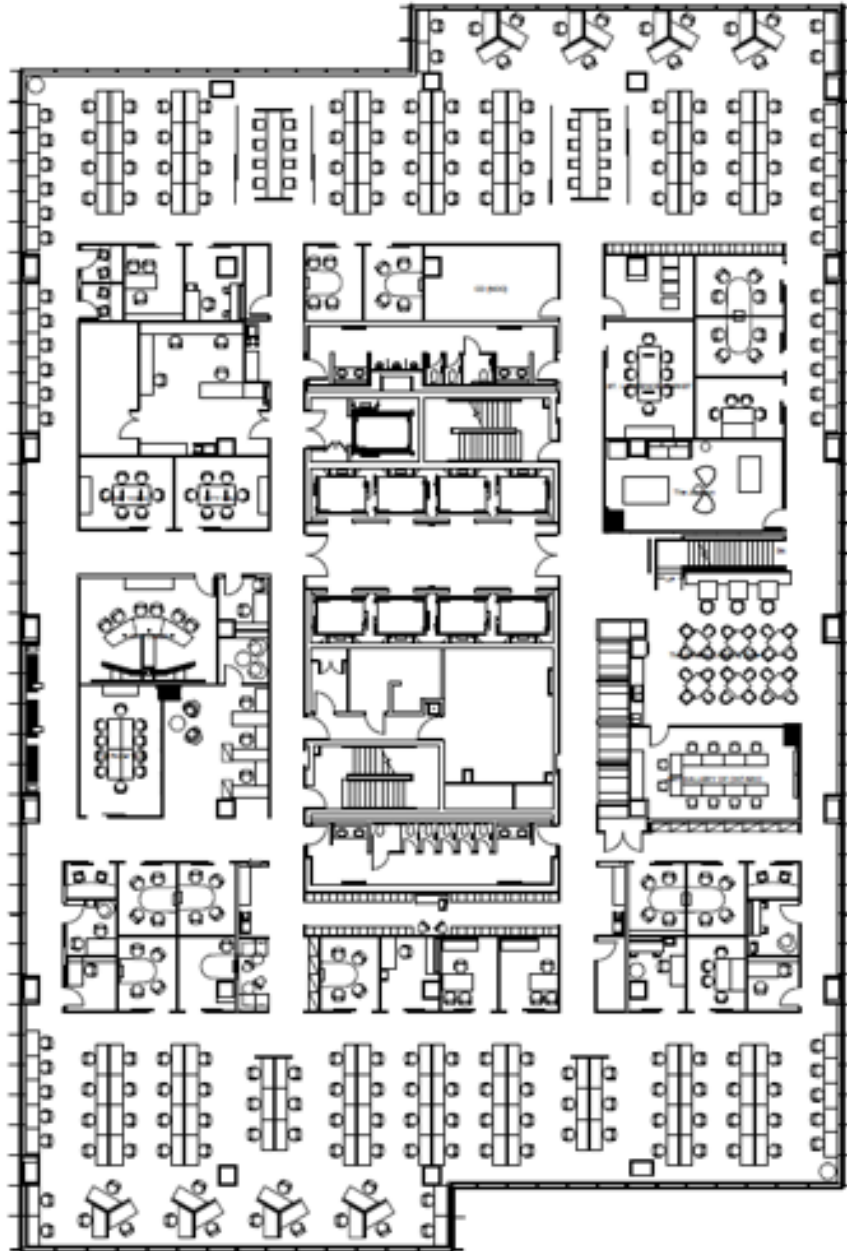

For more information, contact:

**Richard Haig**  
Senior Vice-President  
+1 (416) 304-6014  
[Richard.Haig@am.jll.com](mailto:Richard.Haig@am.jll.com)

# The Space



For more information, contact:

**Richard Haig**  
Senior Vice-President  
+1 (416) 304-6014  
[Richard.Haig@am.jll.com](mailto:Richard.Haig@am.jll.com)