

# St. Louis Business Center

8000 Hall St | Building 4, Suite E

Outside Storage Available



## For Lease

### Suite E overview

Available space:	± 25,000 - 70,805 SF,
Office space:	3,020 SF
Clear span bay spacing:	63' - 78'
Cranes:	Rail system in place
Clear height:	24' - 30'
Dock doors:	2 (9' x 10'), expandable
Drive-in doors:	4 (12' x 14')
Power:	3-phase/600 amp
Fire protection:	ESFR
Outside storage:	Sites available up to ± 8 AC
Security:	Secured business park
Location:	Excellent access to I-70 via new interchange
Asking rate:	\$5.50/SF, NNN

Light Industrial/  
Manufacturing/  
Distribution

**8000 Hall St.  
St. Louis, MO**

**Pat Reilly, SIOR**  
+1 314 338 2085  
patrick.reilly@am.jll.com

**David Branding, SIOR**  
+1 314 338 2084  
david.branding@am.jll.com

[jll.com/stl-ambition](http://jll.com/stl-ambition)



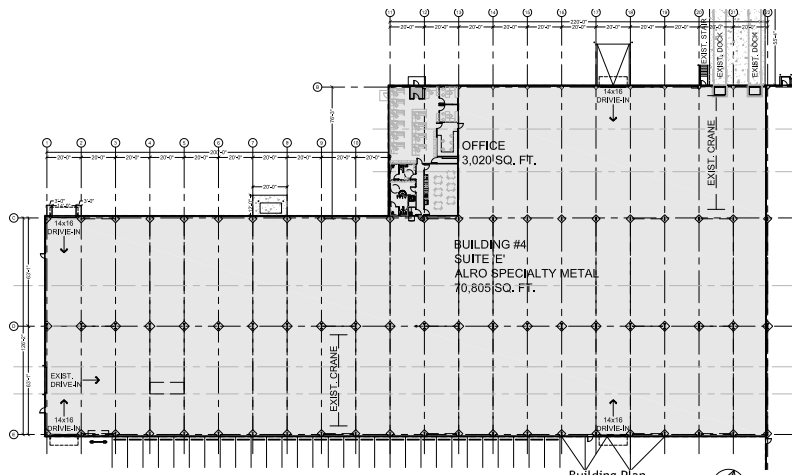

**Building #4 - ALRO STEEL**  
8000 HALL STREET, ST. LOUIS, MO

12.19.16  
SCALE: 1" = 30'-0"  
**TREANORHL**

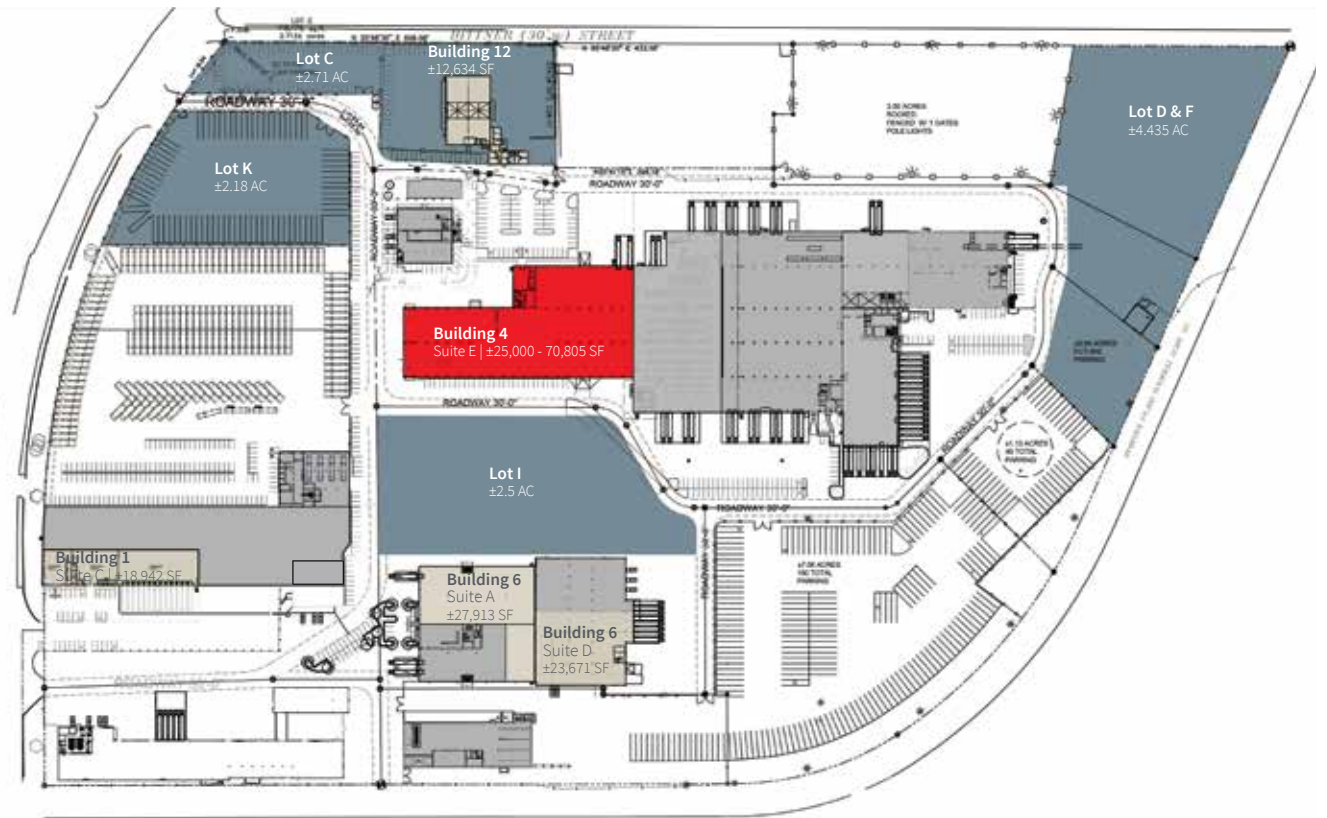
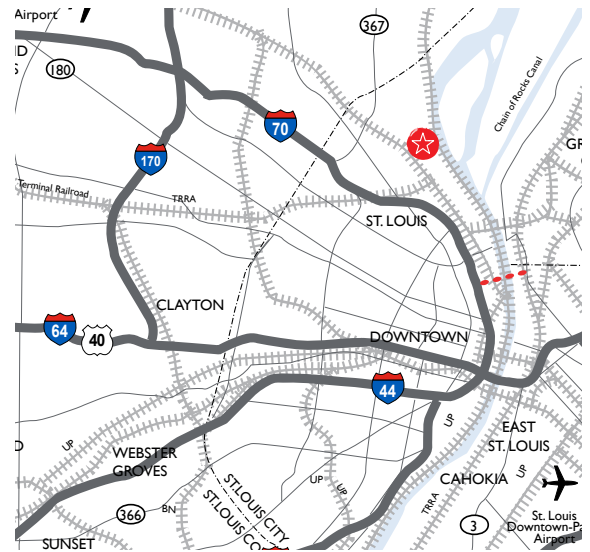

■ Buildings available ■ Lots available ■ Leased ■ Featured space

**Pat Reilly, SIOR**  
+1 314 338 2085  
patrick.reilly@am.jll.com

**David Branding, SIOR**  
+1 314 338 2084  
david.branding@am.jll.com



**DISCLAIMER**  
© 2017 Jones Lang LaSalle IP, Inc. All rights reserved. All information contained herein is from sources deemed reliable; however, no representation or warranty is made to the accuracy thereof.

