

*For Sublease*

69 Yonge Street



## PROPERTY DETAILS

**SUITE SIZE:**

Suite 1300 - 654 sq. ft.

**TERM:**

August 30<sup>th</sup>, 2024

**AVAILABLE:**

Immediate

**NET RENT:**

Negotiable

**ADDITIONAL RENT:**

\$26.04 (2021 estimate)

## SPACE HIGHLIGHTS

- Built out improved space
- Administration, lab/learning space
- Steps from King Street Subway Station
- Furniture could be made available
- Steps from PATH and various amenities

# For Sublease

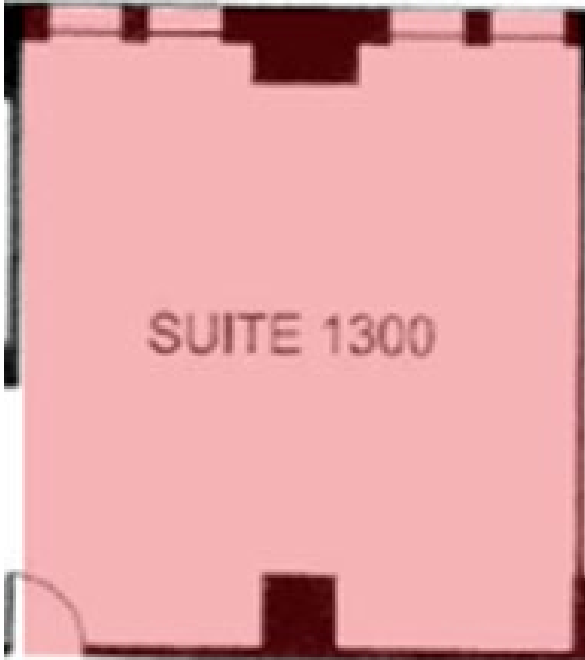

For more information, contact:

**Richard Haig, LEED AP**  
Senior Vice-President  
+1 (416) 304-6014  
[Richard.Haig@am.jll.com](mailto:Richard.Haig@am.jll.com)