



# For Lease

## Long Creek Business Park

### 56,610 s.f. warehouse / distribution space

- Total building: 213,460 s.f.
- Available: 56,610 s.f.
- Office: 4,292 s.f.
- Clear height: 24'
- Column spacing: 50'w x 40'd
- Dock doors: 12
- Drive-in: 2
- Power: 400 amps at 480v  
800 amps at 120/208v
- Sprinkler: ESFR
- Lease rate: \$4.95/s.f. NNN
- Est. NNN expense: \$0.93/s.f.
- Available: February 1, 2018

## 5808-F Long Creek Park Dr Charlotte NC

### Jordan Quinn

+1 704 804 5836

[jordan.quinn@am.jll.com](mailto:jordan.quinn@am.jll.com)

### Brad Cherry, CCIM, SIOR

+1 704 927 3013

[brad.cherry@am.jll.com](mailto:brad.cherry@am.jll.com)

### JLL Charlotte

4201 Congress Street, Suite 300

Charlotte, NC 28209

[www.jll.com/charlotte](http://www.jll.com/charlotte)

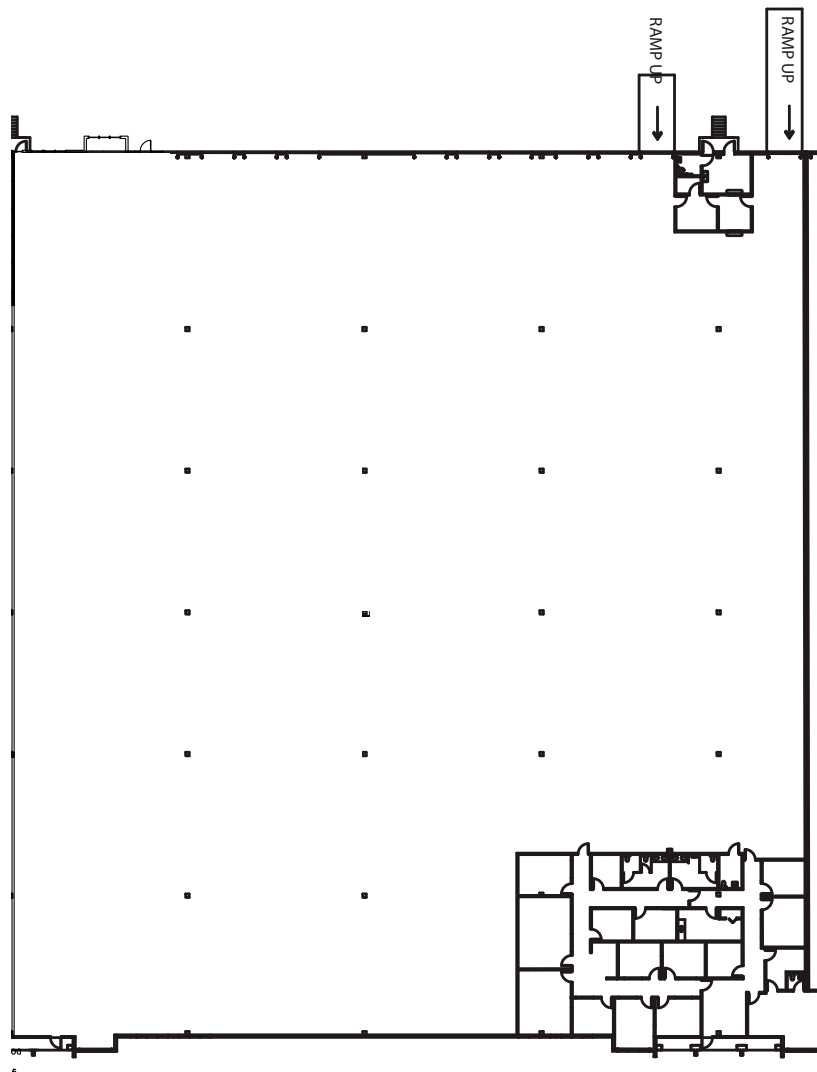
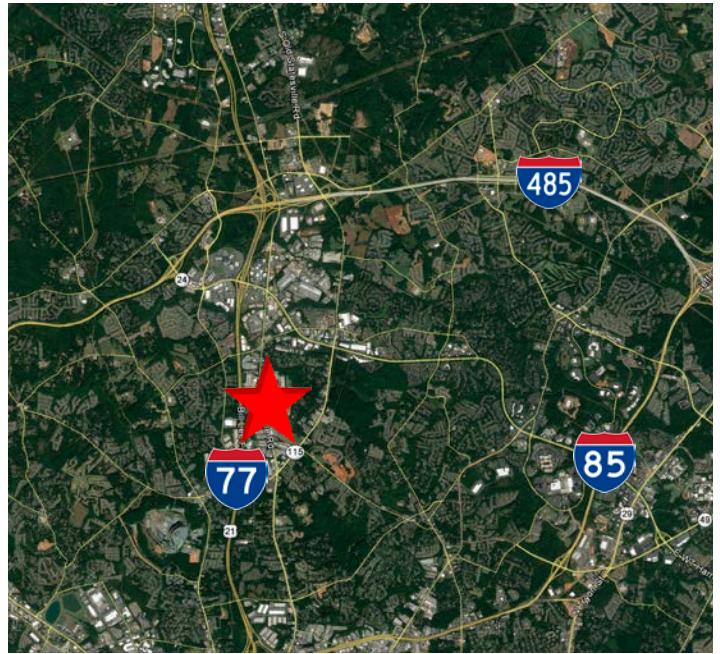

**DISCLAIMER**

© 2017 Jones Lang LaSalle IP, Inc. All rights reserved. All information contained herein is from sources deemed reliable; however, no representation or warranty is made to the accuracy thereof.

