



285 Kings Highway

Brooklyn, NY

Former Walgreens Available for Sublease

Space

Ground Floor: 7,047 sf

Frontage

36'

Ceiling Height

13'

Possession

Arranged

Term

Through 03/31/2028

Asking Rent

\$225,000 per annum gross

Former Duane Reade store #12080

Neighbors



Demographics

Radius	'19 Pop	Total HH	Avg. HHI
.25 Mile	12,095	4,256	\$81,558
.5 Mile	42,630	15,254	\$82,042
.75 Mile	92,934	32,637	\$80,869



Michael Riley
+1 212 812 5901

Michael.Riley@am.jll.com

Patrick A. Smith
+1 212 812 5888

Patricka.Smith@am.jll.com

1476 Route 9

Ground Floor

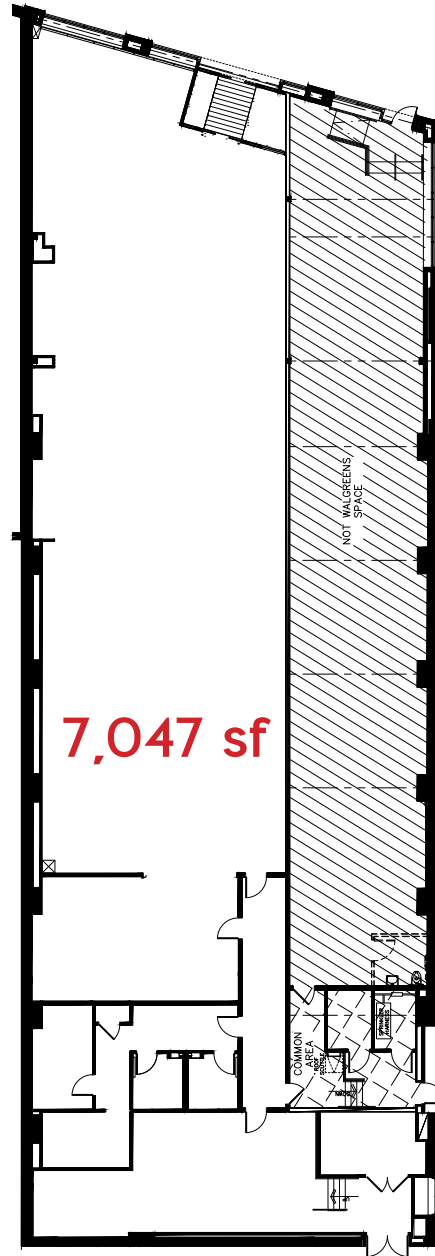

Kings Highway



Jones Lang LaSalle Brokerage, Inc. | 330 Madison Avenue New York, NY 10017

DISCLAIMER

Although information has been obtained from sources deemed reliable, neither Owner nor JLL makes any guarantees, warranties or representations, express or implied, as to the completeness or accuracy as to the information contained herein. Any projections, opinions, assumptions or estimates used are for example only. There may be differences between projected and actual results, and those differences may be material. The Property may be withdrawn without notice. Neither Owner nor JLL accepts any liability for any loss or damage suffered by any party resulting from reliance on this information. If the recipient of this information has signed a confidentiality agreement regarding this matter, this information is subject to the terms of that agreement. ©2020 Jones Lang LaSalle IP, Inc. All rights reserved.