



For Lease

Northwest Edmonton distribution facility with dock and grade loading

- ±41,099 square foot distribution facility
- 2,950 square feet of office area with great natural light from floor to ceiling windows
- Bright, well maintained warehouse area with formidable clear ceiling heights, sawtooth dock loading doors on west elevation, and grade loading doors on south elevation
- Excellent exposure along 178 Street with access to major transportation routes including 170 Street, 184 Street, 118 Avenue, Yellowhead Trail, and Anthony Henday Drive

178 Street Warehouse 11619 178 Street, Edmonton

Adam Butler

+1 780 328 0065

adam.butler@am.jll.com

Darryl McGavigan

+1 780 328 0064

darryl.mcgavigan@am.jll.com

David Kraus

+1 780 328 0068

david.kraus@am.jll.com

Jim Bijou

+1 780 328 2551

jim.bijou@am.jll.com

Andres Mateluna

+1 780 328 2557

andres.mateluna@am.jll.com





- **Available Area:** ±41,099 square feet
- **Zoning:** IM - Medium Industrial
- **Power:** 600 amp, 600 volt (TBC)
- **Heating:** Forced air and gas fired units
- **Lighting:** LED
- **Loading:**
 - Four 8' x 10' dock doors with levelers
 - One 10' x 12' grade door
 - One 12' x 12' grade door
- **Ceiling Height:** 24' - 28' clear
- **Lease Rate:** \$5.24 PSF
- **Operating Costs:** \$3.55 PSF (2017)
- **Available:** Immediately

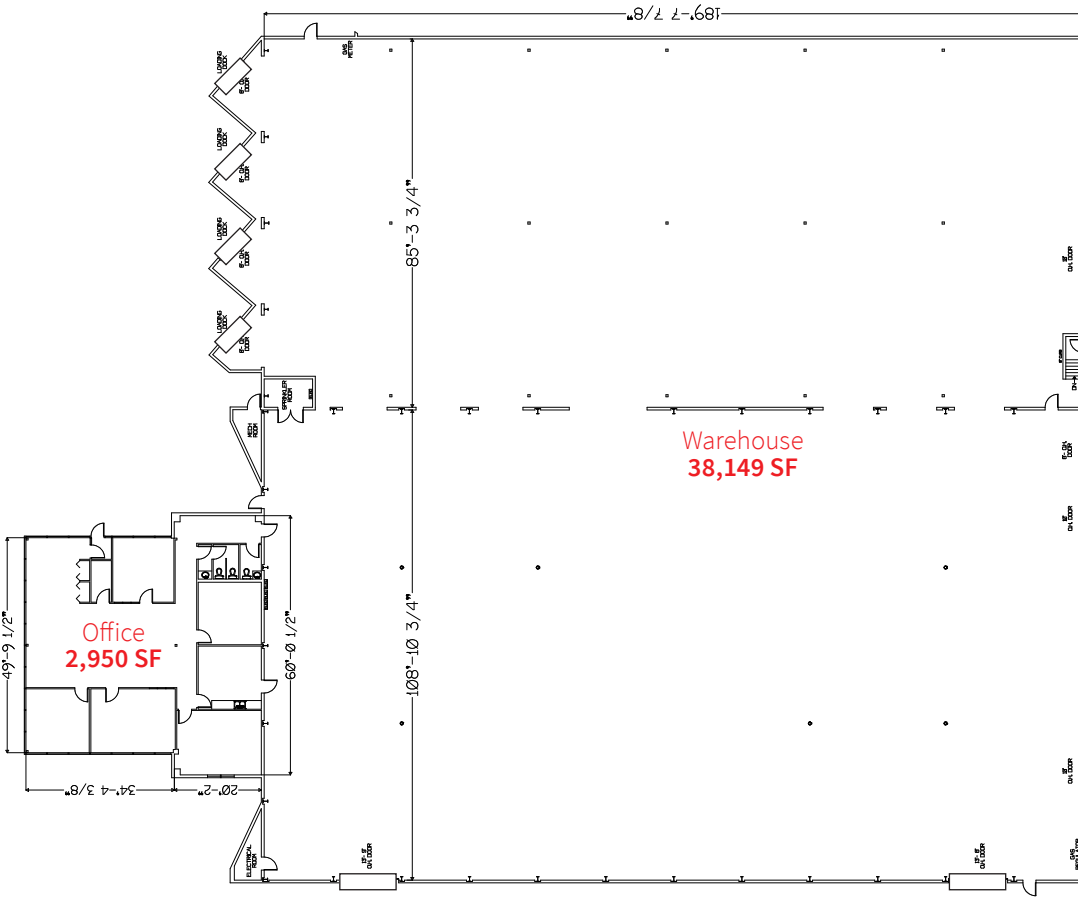

Plans

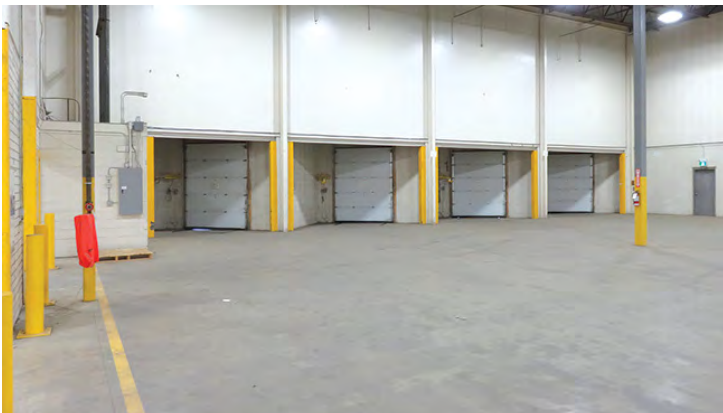
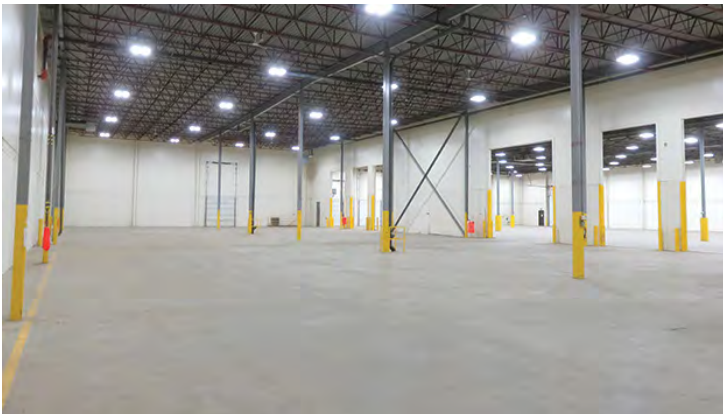



Contact the Edmonton Industrial Sales & Leasing Team

Adam Butler

Associate Vice President
+1 780 328 0065
adam.butler@am.jll.com

Andres Mateluna

Senior Associate
+1 780 328 2557
andres.mateluna@am.jll.com

Darryl McGavigan

Vice President
+1 780 328 0064
darryl.mcgavigan@am.jll.com

David Kraus

Vice President
+1 780 328 0068
david.kraus@am.jll.com

Jim Bijou

Senior Vice President
+1 780 328 2551
jim.bijou@am.jll.com

Ashley Hodgins

Brokerage Coordinator
+1 780 328 0069
ashley.hodgins@am.jll.com

Karrone Young

Marketing Coordinator
+1 780 328 2583
karrone.young@am.jll.com

Daniel Toumine

Research Analyst
+1 780 328 0070
daniel.toumine@am.jll.com

DISCLAIMER: Although information has been obtained from sources deemed reliable, neither Owner nor JLL makes any guarantees, warranties or representations, express or implied, as to the completeness or accuracy as to the information contained herein. Any projections, opinions, assumptions or estimates used are for example only. There may be differences between projected and actual results, and those differences may be material. The Property may be withdrawn without notice. Neither Owner nor JLL accepts any liability for any loss or damage suffered by any party resulting from reliance on this information. If the recipient of this information has signed a confidentiality agreement regarding this matter, this information is subject to the terms of that agreement. ©2019. Jones Lang LaSalle IP, Inc. All rights reserved.

JLL Edmonton Industrial
Suite 2101 TD Tower
10088 102 Ave. NW
Edmonton, AB, T5J 2Z1