

For Lease

MOVE-IN READY



Westfork Industrial Center | Building 7 20,000 s.f. available

1701 Westfork Road - Suite 109
Lithia Springs, GA 30122



Property Highlights

- 60,000 s.f. total building size
- 20,000 s.f. total available
- 1,144 s.f. office
- 130' building depth
- 20' clear height
- 25'd x 40'w column spacing
- Rear load
- 8 dock high doors
- 90' truck court depth
- Fully sprinklered
- T-5 lighting
- Opportunity Zone



Reed Davis
O: +1 404 995 2227
M: +1 404 844 9128
reed.davis@am.jll.com



Location

- Located 2.3 miles off of I-20 in Douglas County
- Hartsfield-Jackson Atlanta Airport: 24.1 miles
- Atlanta Center: 16.6 miles
- Intermodals:
 - Austell, GA – 4 miles
 - Fairburn, GA – 28.6 miles

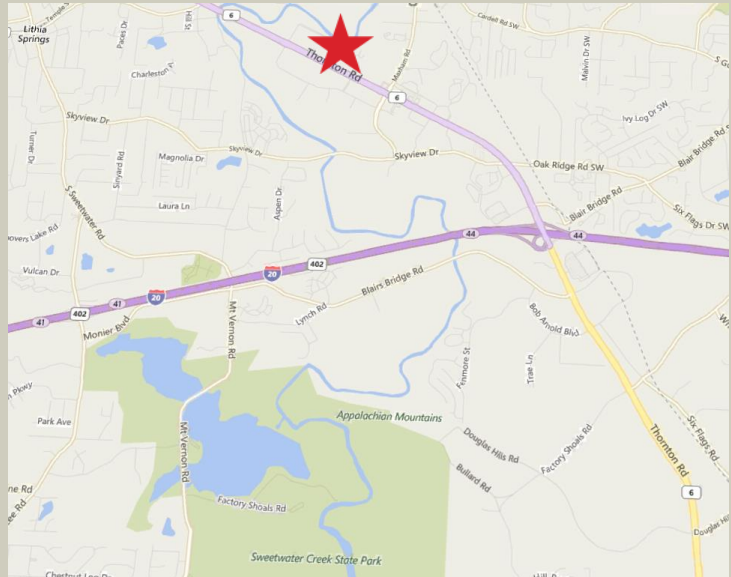

Floorplan

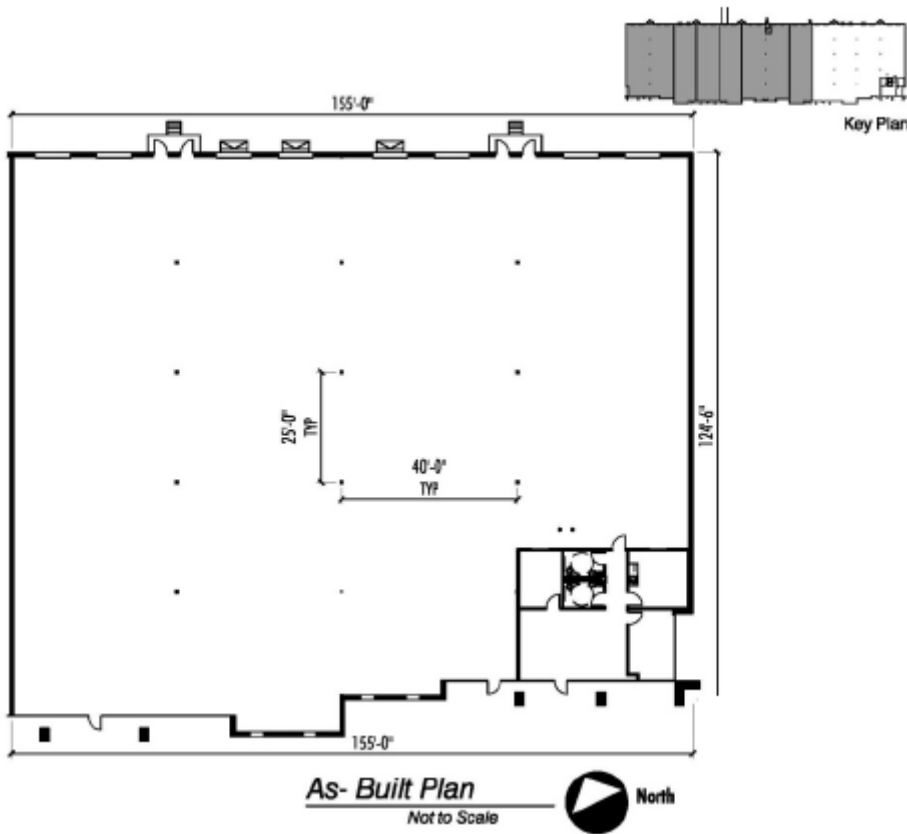

Suite 109
20,000 s.f. total available
1,144 s.f. office
18,856 s.f. warehouse



Reed Davis
O: +1 404 995 2227
M: +1 404 844 9128
reed.davis@am.jll.com

