

Andover East Business Center Building B

16,280 Square Feet Industrial Space For Lease

1097 Andover Park East, Tukwila, WA 98188



Features

Location

- Strategic distribution location
- Located on major North/South arterial, connecting to I-405 and immediate access to I-5
- Just minutes from SeaTac International Airport
- Professionally maintained landscaping

General Features

- Total of 16,280 SF
- 1,425 SF office
- 22' clear height
- 21' 2" x 55' column spacing
- 5 dock high overhead doors
- 39/5600 wet sprinkler system
- 128' truck court
- 148' minimum bay depth
- Available on 30 day notice

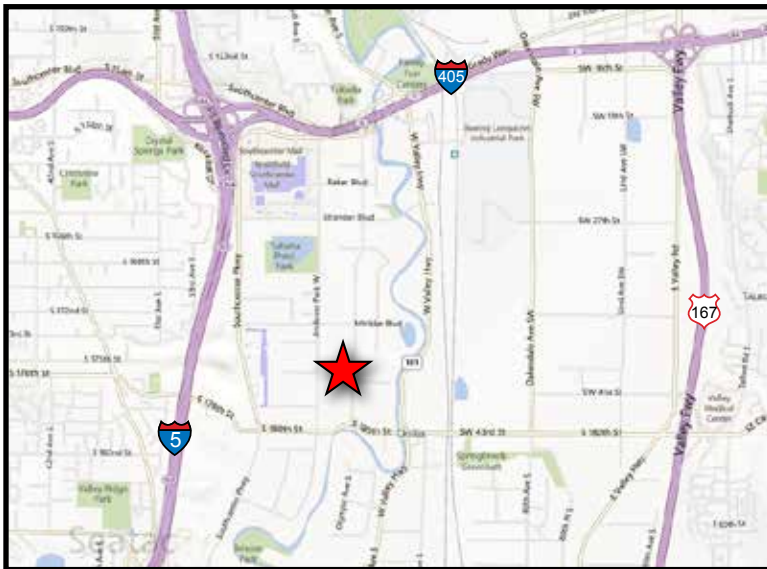

SCOTT CARTER
+1 425 974 4004
scott.carter@am.jll.com

LES BOUDWIN, SIOR
+1 425 974 4023
les.boudwin@am.jll.com



Andover East Business Center

Building B

16,280 Square Feet Industrial Space For Lease

1097 Andover Park East, Tukwila, WA 98188

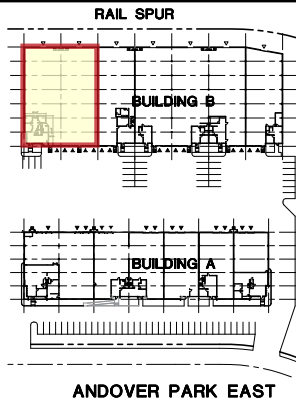

BUILDING AREA
1,425 SQ.FT. OFFICE
14,855 SQ.FT. WAREHOUSE
16,280 SQ.FT. TOTAL

LEGEND

- ▼ DOCK-HIGH OVERHEAD DOOR
- RAIL DOORS

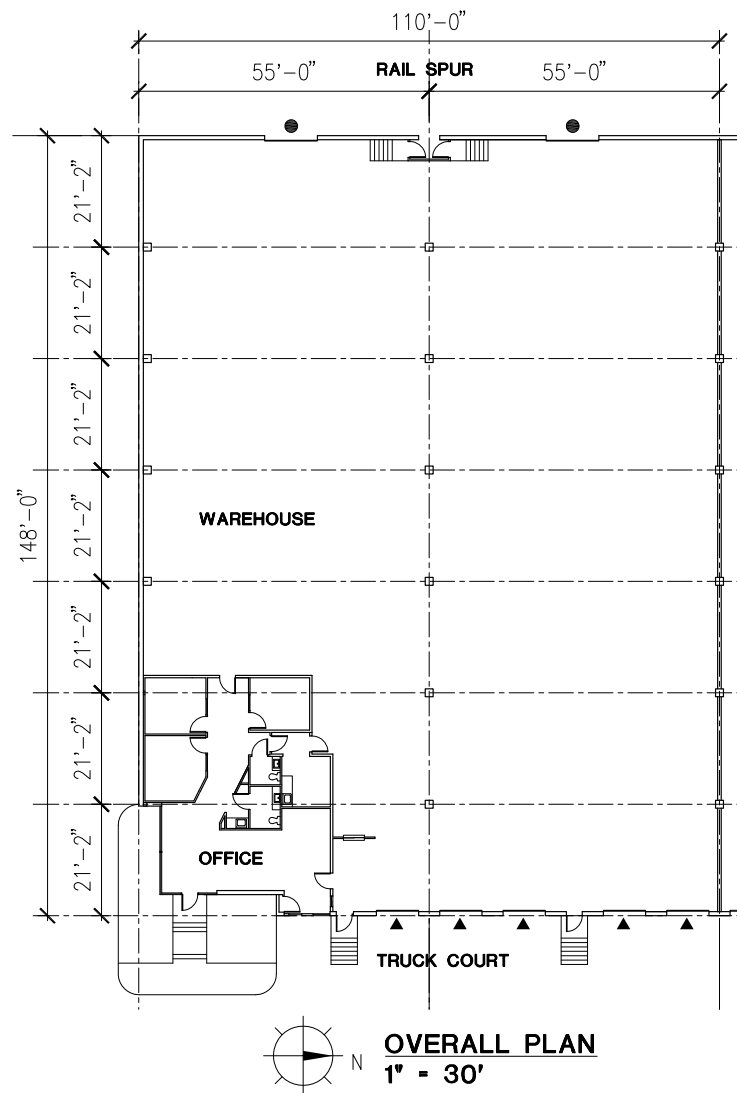
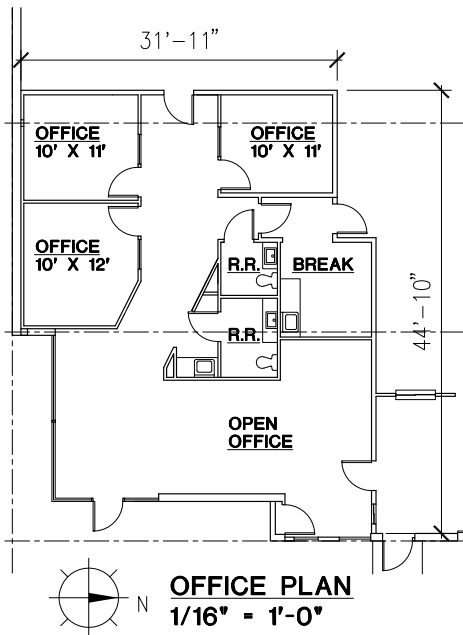

SCOTT CARTER
+1 425 974 4004
scott.carter@am.jll.com

LES BOUDWIN, SIOR
+1 425 974 4023
les.boudwin@am.jll.com

