



3 Beaver Valley Road | Wilmington, DE

# 3 Beaver Valley Road Wilmington, DE Plug and Play Sublease

## Contact information

**Blaise Fletcher**  
[Blaise.Fletcher@am.jll.com](mailto:Blaise.Fletcher@am.jll.com)  
+1 302 356 2861

**Jamie Vari**  
[Jamie.Vari@am.jll.com](mailto:Jamie.Vari@am.jll.com)  
+1 302 356 2862

222 Delaware Avenue | Suite 1610  
Wilmington, DE 19801 | +1 302 356 2858

[www.jll.com/philadelphia](http://www.jll.com/philadelphia)

## Sublease

### Property features

- Entire 4<sup>th</sup> floor – 53,017 RSF (divisible)
- Lease term through December 2024 (with flexibility to expire as early as December 2021)

### Amenities

- Existing furniture systems available
- Café on site
- Structured parking

### Location

- Located at the intersection of Concord Pike (Route 202) and Naamans Road (Route 92)
- Within minutes of the Pennsylvania State line
- Shopping and banking adjacent to property



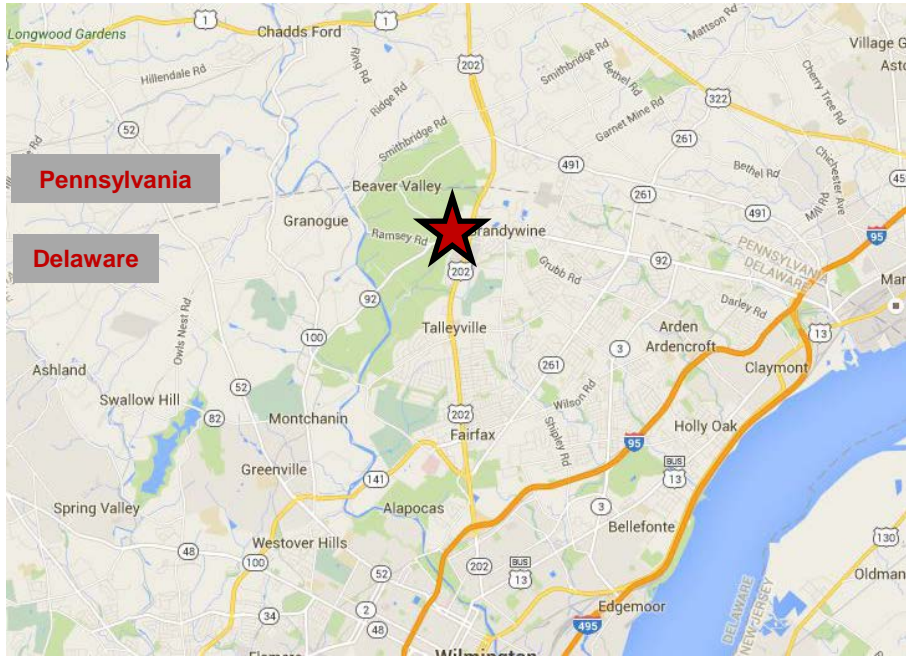
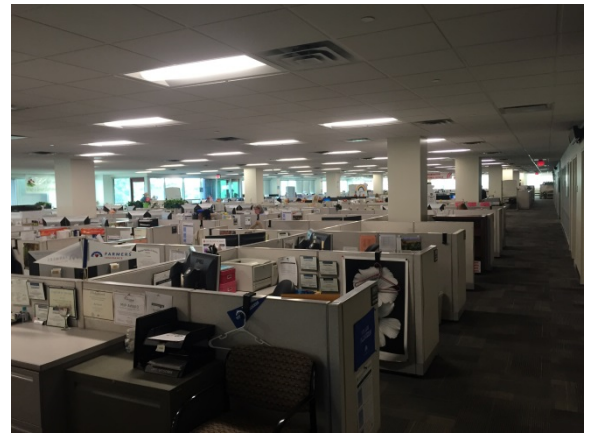
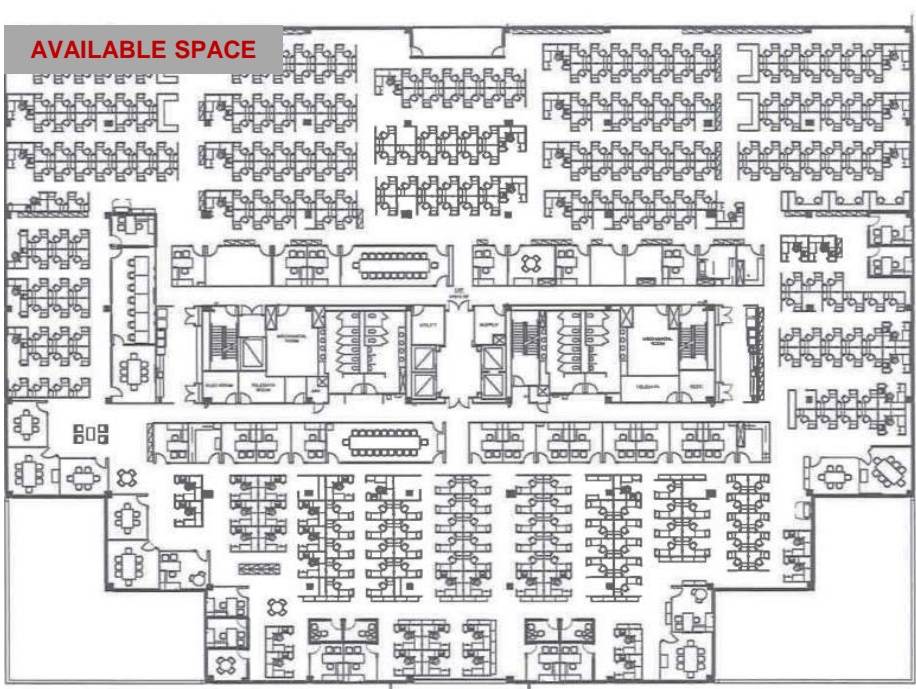

# 3 Beaver Valley Road Wilmington, DE

## Contact information

Blaise Fletcher  
[Blaise.Fletcher@am.jll.com](mailto:Blaise.Fletcher@am.jll.com)  
 +1 302 356 2861

Jamie Vari  
[Jamie.Vari@am.jll.com](mailto:Jamie.Vari@am.jll.com)  
 +1 302 356 2862

222 Delaware Avenue | Suite 1610  
 Wilmington, DE | +1 302 356 2858

[www.jll.com/philadelphia](http://www.jll.com/philadelphia)

