



For Sublease

2600 E. Saucon Valley Road, Center Valley PA

5,000 - 15,000 s.f.
available

Sublease through
September 2020

- 25' x 50' column spacing
- Roof mounted gas-fired heaters
- Can be fully demised with separate front entrance, loading door, and restroom/office
- Central Lehigh Valley location



DISCLAIMER

Although information has been obtained from sources deemed reliable, Owner, Jones Lang LaSalle, and/or their representatives, brokers or agents make no guarantees as to the accuracy of the information contained herein, and offer the Property 2018. Jones Lang LaSalle. All rights reserved.

Local map

- Located off Route 309
- Easy access to I-78, Route 309, Route 378, and minutes to the Pennsylvania Turnpike

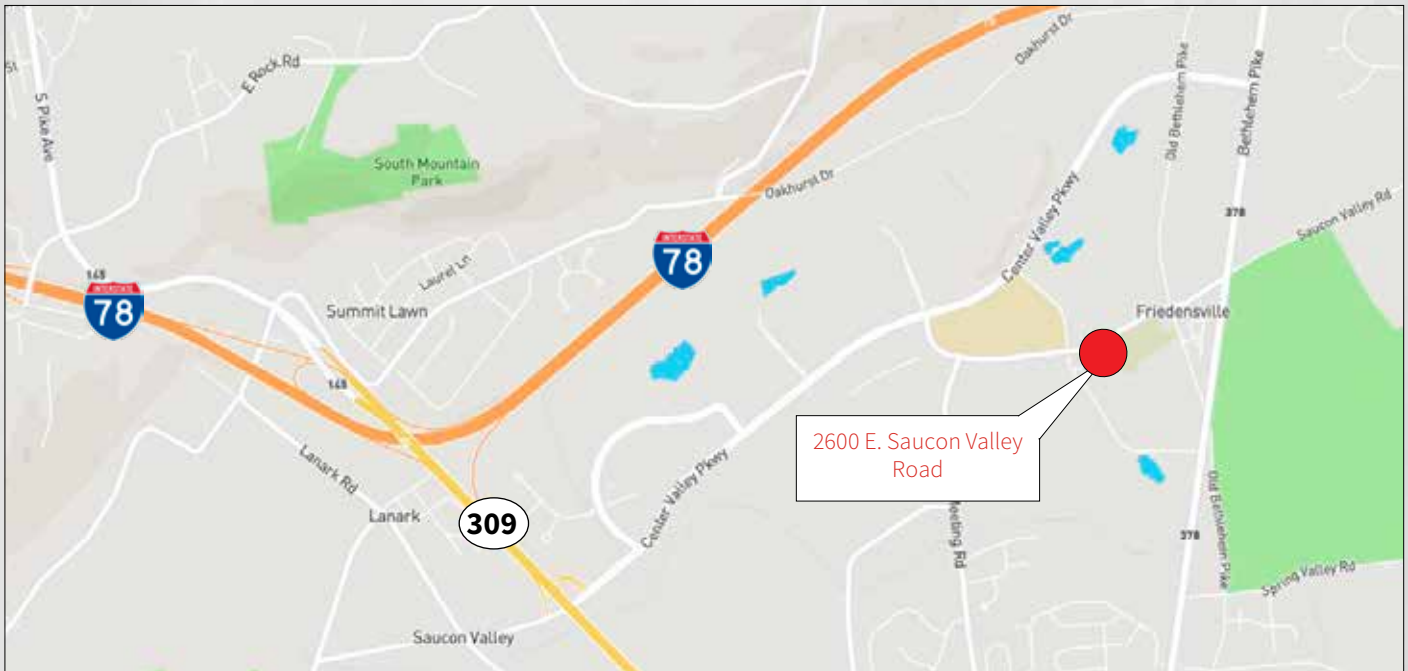

Interior

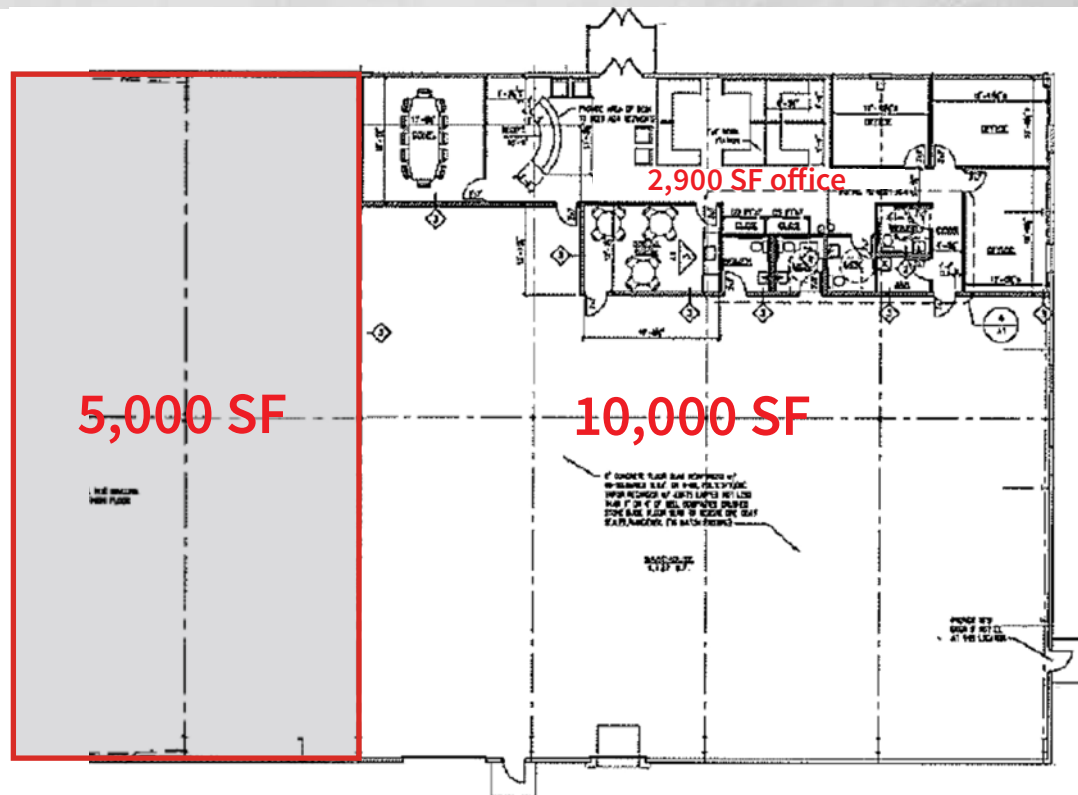

Kim Jacobsen
Managing Director
+1 484 635 3226
kim.jacobsen@am.jll.com

Lee Fittipaldi
Associate Vice President
+1 484 635 3225
lee.fittipaldi@am.jll.com

JLL | Jones Lang LaSalle
1495 Valley Center Parkway, Suite 100
Bethlehem, PA 18017
+1 484 635 3300
www.jll.com/industrial

DISCLAIMER
Although information has been obtained from sources deemed reliable, Owner, Jones Lang LaSalle, and/or their representatives, brokers or agents make no guarantees as to the accuracy of the information contained herein, and offer the Property 2018. Jones Lang LaSalle. All rights reserved.

