

31,661 SF AVAILABLE INDUSTRIAL SPACE FOR LEASE

Kyrene Commons South
9035 S Kyrene Road • Tempe Arizona



Building Features

- ±31,661 s.f. industrial space
- ±26,726 s.f. air conditioned warehouse
- ±4,935 s.f. office
- (2) grade level doors
- (3) Dock high doors
- 100% A/C warehouse
- 23' Clear height
- Zoned GID - City of Tempe
- ESFR sprinklered
- 2000 amps 277/480v, 3p

For additional information:

Steve Sayre
Executive Vice President
+1 602 282 6299
steve.sayre@am.jll.com

Kyle Westfall
Associate
+1 602 282 6297
kyle.westfall@am.jll.com

Pat Harlan MCR
Executive Vice President
+1 602 282 6298
pat.harlan@am.jll.com

9035 S Kyrene Road • Tempe Arizona

Floor plan

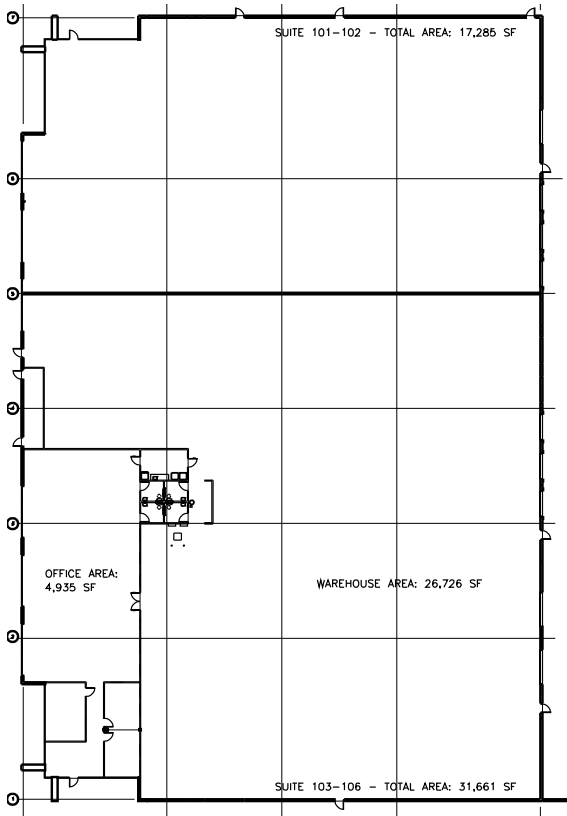

STOCKBRIDGE
CAPITAL GROUP

For additional information:

Steve Sayre
Executive Vice President
+1 602 282 6299
steve.sayre@am.jll.com

Kyle Westfall
Associate
+1 602 282 6297
kyle.westfall@am.jll.com

Pat Harlan MCR
Executive Vice President
+1 602 282 6298
pat.harlan@am.jll.com

