

±5,510 SF WAREHOUSE SPACE AVAILABLE FOR LEASE

FOR LEASE



495 EDISON COURT | SUITE D | FAIRFIELD, CA

SUITE D HIGHLIGHTS:

- ±5,510 SF Warehouse Space for Lease
- ±500 SF Office Area
- ±300 SF Food-Grade Processing Room
- 22' Clear Height in Warehouse Area
- 200 Amps of 120/208 Service
- One 12' x 14' Grade-Level Loading Door

LOCATION DETAILS:

495, 497, 499 Edison Court is a uniquely well-located and highly-visible multi-tenant light industrial property in the Cordelia Industrial Park at the intersection of Interstates 80, 680 and Highway 12.

Located midway between San Francisco / Oakland and Sacramento, the Property has excellent access to Napa and Solano Counties and the surrounding Bay Area. The buildings offers 22'-26' clear heights, convenient parking, and flexible floor plans.



CHRIS NEEB
chris.neeb@am.jll.com
(707) 495 7777
RE License No: 01324612

THE DOWLING-BRACCO TEAM OF JLL
WWW.DBREA.COM | WWW.JLL.COM



495 EDISON COURT Fairfield, CA

FLOOR PLAN

±5,510 SF SPACE FOR LEASE

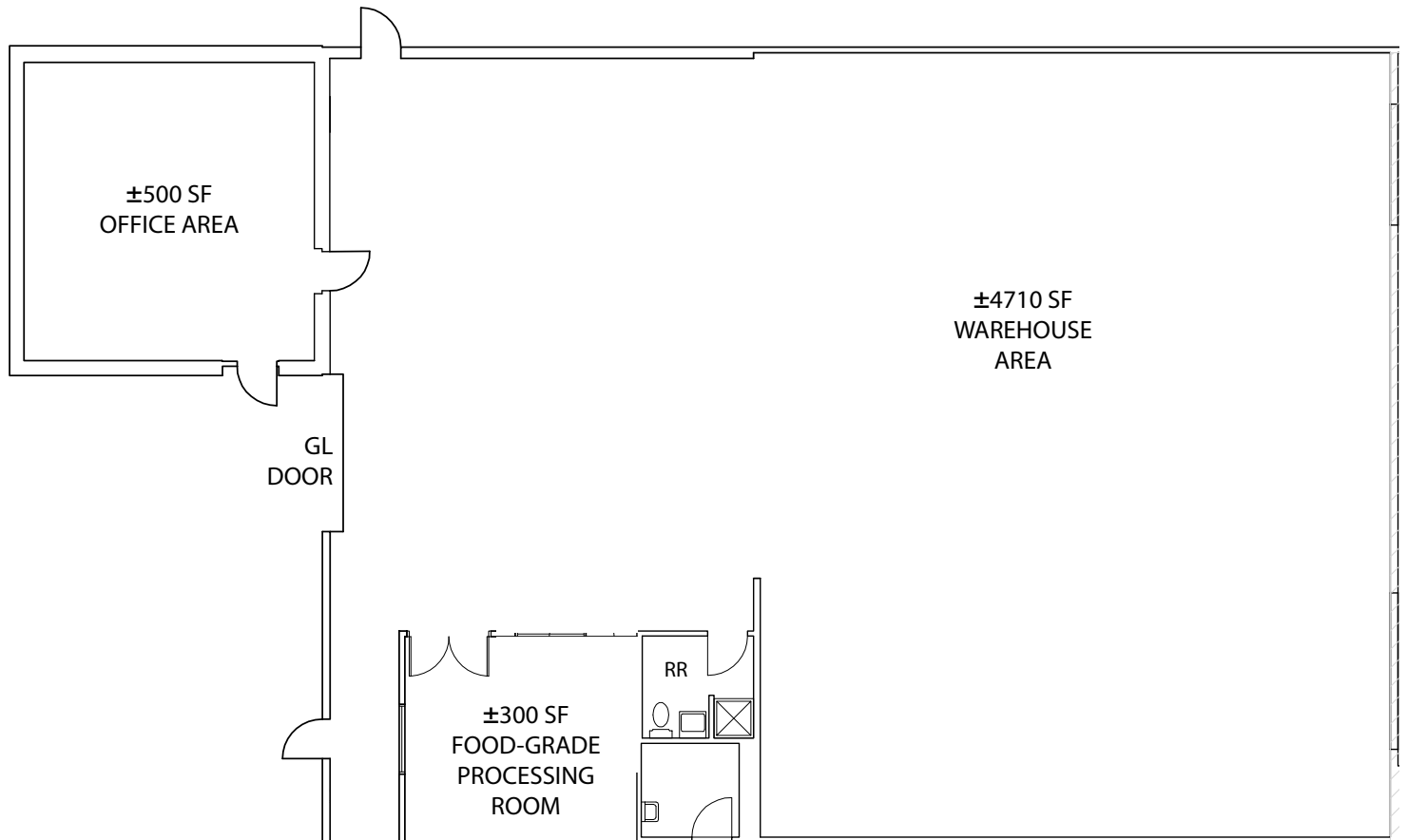

CHRIS NEEB
chris.neeb@am.jll.com
(707) 495 7777
RE License No: 01324612

THE DOWLING-BRACCO TEAM OF JLL
WWW.DBREA.COM | WWW.JLL.COM

