

FOR LEASE



→ OVERVIEW

72,000 SF office warehouse building for lease:

- Great West Chester location with easy access to Interstates 275 and 75
- No Earnings Tax
- Aggressive rental rates
- Negotiable lease terms
- Flexible floor plans
- Clean and well maintained

→ PROPERTY STATISTICS

Available SF
8,000 sf Total
2,500 sf Office
5,500 sf WH

Clearance Height
20 feet

Number of Docks
Two (2) 9' x 10'

Number of Drive Ins
One (1) 12' x 14'

Parking Facilities
2 / 1,000 SF parking

Sprinkler System
Wet Sprinkler System

Electrical Service
208v / 3Ph 350 amps

Zoning
M2 Industrial

Lighting
T-8 Lights in office & warehouse

Column Spacing
40' x 50'

Great space layout for offices, showroom and conference/training

9860 Windisch Rd
West Chester, Ohio 45069

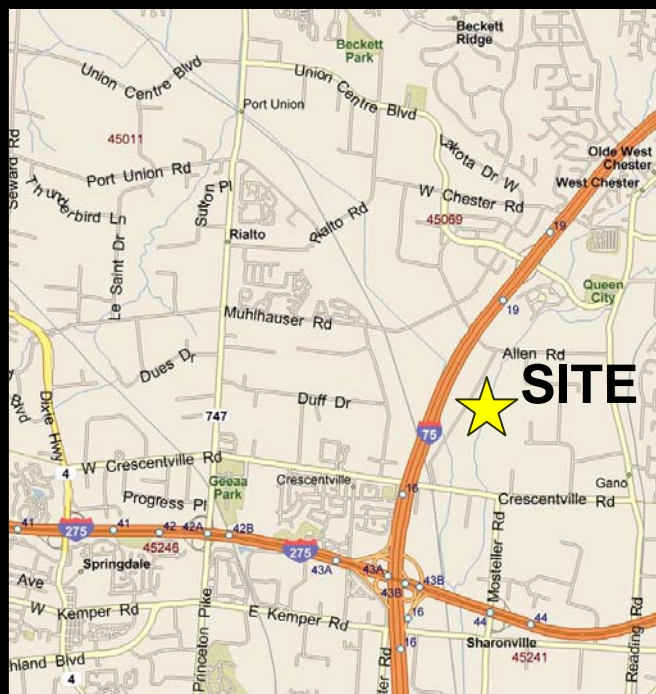

<http://www.loopnet.com/lid/16749744>

FIRST INDUSTRIAL REALTY TRUST

9912 Windisch Road, West Chester, OH 45069

T: (513) 860-0480 F: (513) 860-4702 www.firstindustrial.com



9860 Windisch Road
West Chester, OH

FOR LEASE

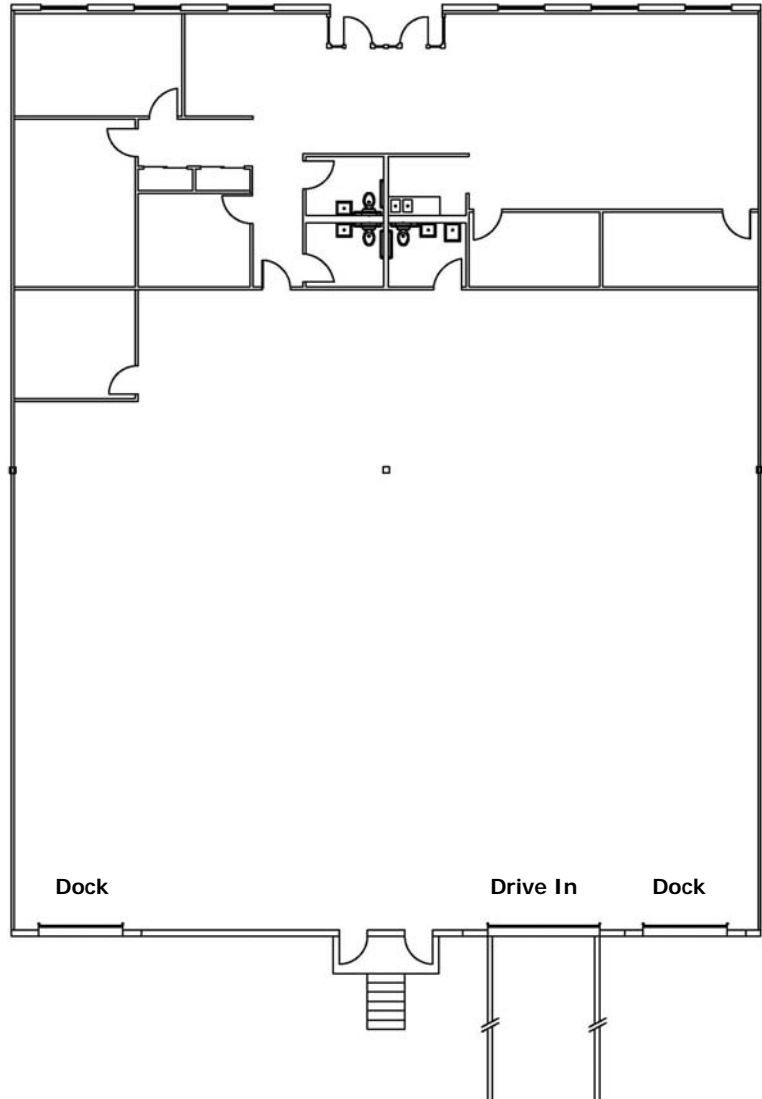

→ CONTACT

For more information contact:

Brett E. Connelly Sr.
Senior Associate
+1 513 252 2148
brett.connelly@am.jll.com
www.us.joneslanglasalle.com

Mark G. Volkman, SIOR
Senior Vice President
+1 513 252 2123
mark.volkman@am.jll.com
www.us.joneslanglasalle.com



Real value in a changing world

All information furnished regarding the property for sale, rental or financing is obtained from sources deemed reliable. No representation is made to the accuracy thereof and is submitted subject to errors, omission, change of price rental or other conditions, prior sale, lease, or financing, or withdrawal without notice. First Industrial Realty Trust, Inc. represents the Seller in this transaction and as such owes all duties and obligations thereto.

FIRST INDUSTRIAL REALTY TRUST
9912 Windisch Road, West Chester, OH 45069
T: (513) 860-0480 F: (513) 860-4702 www.firstindustrial.com

